

Advantix stacking element

Instructions for Use

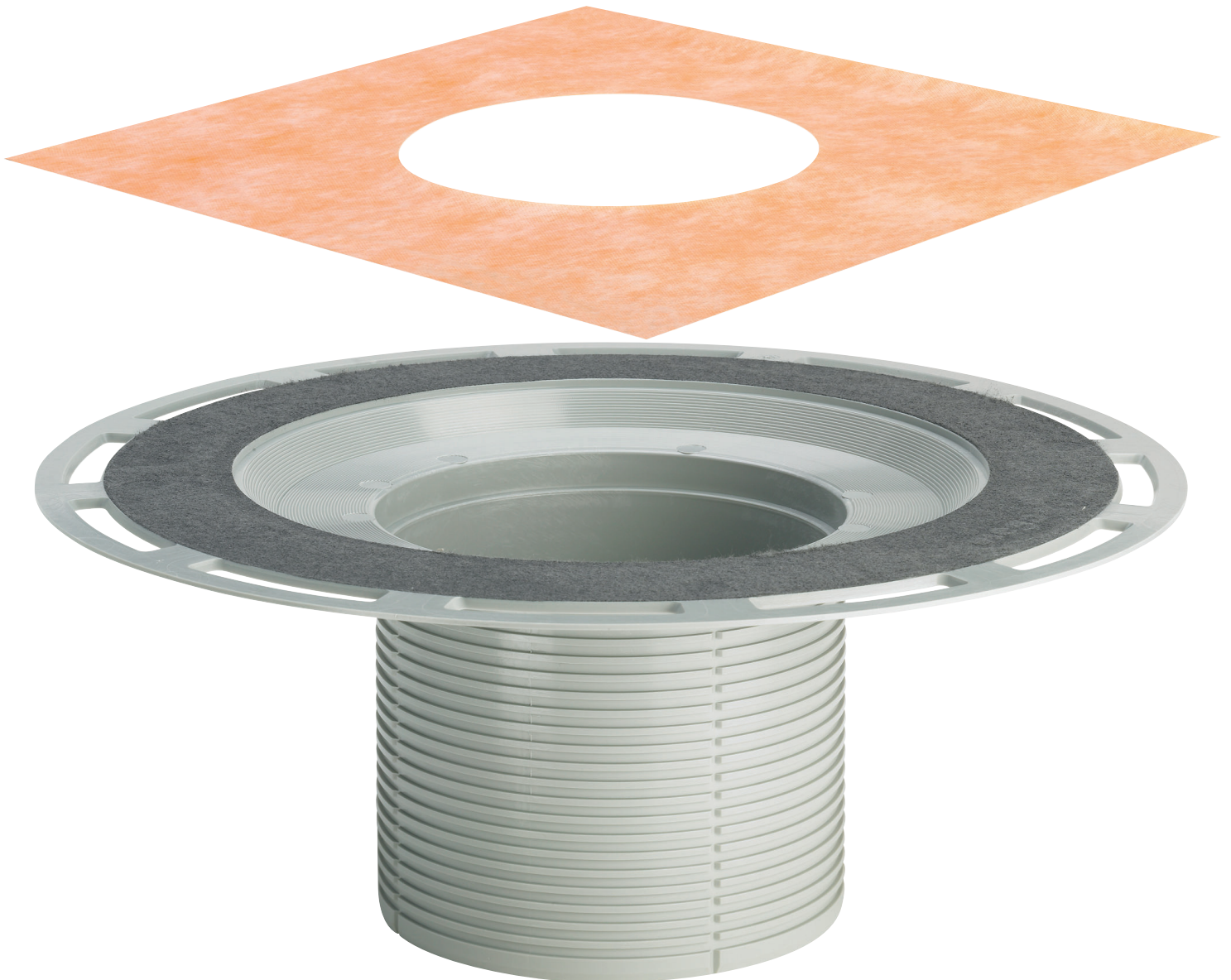

for bonded sealing (tiled shower) with liquid foil or sealing mat

Model
4994

Year built:
from 01/2004

en_INT

viega

Table of contents

1	About this instruction for use	4
1.1	Target groups	4
1.2	Labelling of notes	4
1.3	About this translated version	5
2	Product information	6
2.1	Intended use	6
2.1.1	Areas of use	6
2.1.2	Media	6
2.2	Product description	6
2.2.1	Overview	6
2.3	Information for use	7
2.3.1	Sealing	7
2.4	Required accessories	9
3	Handling	10
3.1	Assembly information	10
3.1.1	Important note	10
3.1.2	Installation dimensions	10
3.1.3	Tools and materials	10
3.2	Assembly	11
3.2.1	Mounting stacking element	11
3.2.2	Sealing the drain	12
3.2.3	Mounting the top	15
3.3	Disposal	16

1 About this instruction for use

Trade mark rights exist for this document, further information can be found at www.viega.com/legal-notice.

1.1 Target groups

The information in this instruction manual is directed at the following groups of people:

- Heating and sanitary professionals and trained personnel
- Tilers

It is not permitted for individuals without the abovementioned training or qualification to mount, install and, if required, service this product. This restriction does not extend to possible operating instructions.

The installation of Viega products must take place in accordance with the general rules of engineering and the Viega instructions for use.

1.2 Labelling of notes

Warning and advisory texts are set aside from the remainder of the text and are labelled with the relevant pictographs.



DANGER!

This symbol warns against possible life-threatening injury.



WARNING!

This symbol warns against possible serious injury.



CAUTION!

This symbol warns against possible injury.



NOTICE!

This symbol warns against possible damage to property.



Notes give you additional helpful tips.

1.3 About this translated version

This instruction for use contains important information about the choice of product or system, assembly and commissioning as well as intended use and, if required, maintenance measures. The information about the products, their properties and application technology are based on the current standards in Europe (e. g. EN) and/or in Germany (e. g. DIN/DVGW).

Some passages in the text may refer to technical codes in Europe/Germany. These should serve as recommendations in the absence of corresponding national regulations. The pertinent national laws, standards, regulations and guidelines, as well as other technical guidelines, have priority over German/European guidelines in this manual: The information is not binding for other countries and territories and should, as mentioned, be considered as support.

2 Product information

2.1 Intended use

2.1.1 Areas of use

The stacking element is intended for the raising and bonded sealing of an Advantix drain above the cement layers.

2.1.2 Media

Drain and stacking element are intended to be in constant operation for the channelling off of typical household wastewater in acc. with DIN 1986-3.

- The short-term temperature of the wastewater may reach up to 95° C. The temperature must be considerably lower in constant operation.
- The pH value must be higher than 4 but lower than 10.

It is not permitted to introduce wastewater which would damage the product material.

2.2 Product description

2.2.1 Overview

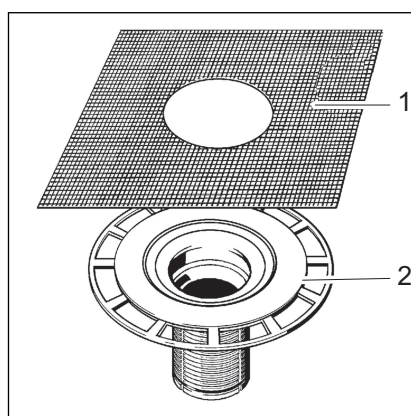

Fig. 1: Components stacking element model 4994

- 1 - sealing collar
- 2 - stacking element with flange for the application of the bonded sealing

2.3 Information for use

2.3.1 Sealing

Bonded sealing

To protect against dampness, sealing foils which are to be processed as liquids are applied directly below the tiles on screed and walls. The provisions of the wear class, of the foundation and the choice of suitable bonded sealing must be carried out in acc. with ZBD data sheet 1/2010 and in acc. with the guideline for bonded sealing (BS).

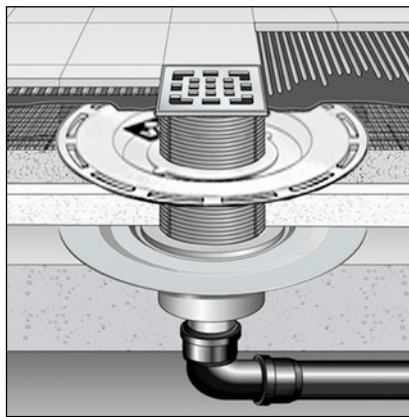

Fig. 2: Diagram of a bonded seal with stacking element

Important note

Careful planning is required for professional sealing. In addition, depending on the individual dampness wear class and the type of foundation, a suitable BS system with a building regulations certificate of suitability must be chosen.

Furthermore, the following factors should be taken into account:

- Drain or shower channel must be equipped with a special flange, which has an adhesive surface and a width of at least 30 mm
- To enable the material change from drain to screed, either a suitable sealing cuff or sealing strip, which is designed for overlapping with the BS with a width of at least 50 mm must be used.
- The screed must be laid at a minimum incline of 1–2 %.
- The installation must be carried out properly in acc. with the installation manual and the manufacturer's information.

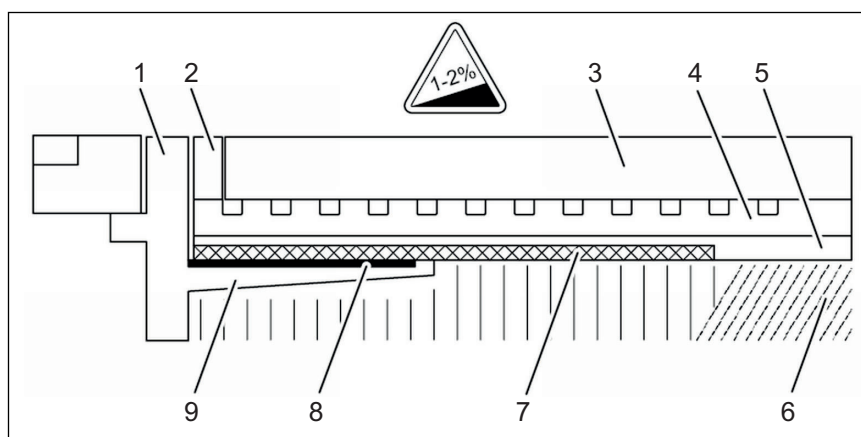

Fig. 3: Construction diagram of the bonded seal - min. screed incline 1–2 %

- 1 - grate
- 2 - top piece with adhesive flange
- 3 - tile
- 4 - tile adhesive
- 5 - bonded sealing
- 6 - screed
- 7 - sealing cuff
- 8 - mat
- 9 - adhesive flange

Permitted bonded seals

Only approved bonded seals with proof of practicability in keeping with building law may be used with suitable drains, e. g.:

- for the wear classes A and AO:
in accordance with ETAG 022 T1
- for the wear classes A, B and C:
in accordance with DiBt Rule list A, Part 2 of the DiBt and the test principles for bonded sealing (PG AIV-F)
- in acc. with DIN EN 14891:
"Liquid-applied impermeable products for use below ceramic tiling bonded with adhesives"

Information regarding the procedure can be found in the instructions for use of the corresponding product.

2.4 Required accessories

Top

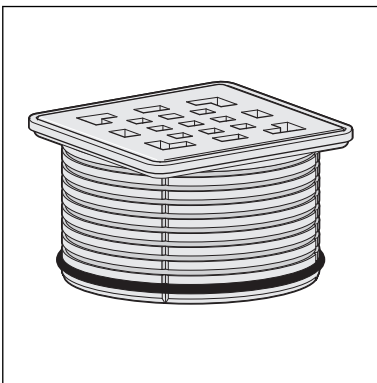

A top must be purchased separately to complete the mounting of the drain.

Advantix tops are available in a number of sizes and variations. You can also only buy an Advantix top frame and then purchase a suitable designer grate separately (see catalogue).

3 Handling

3.1 Assembly information

3.1.1 Important note

Before assembly:

- check if the installation height of the drain and stacking element corresponds with the planned floor construction
- ensure that the drain has been fully lined with mortar
- if necessary, supply the required accessories ↗ *Chapter 2.4 'Required accessories' on page 9*

During assembly:

- observe installation dimensions

After assembly:

- The flange must be fully lined with mortar.

3.1.2 Installation dimensions

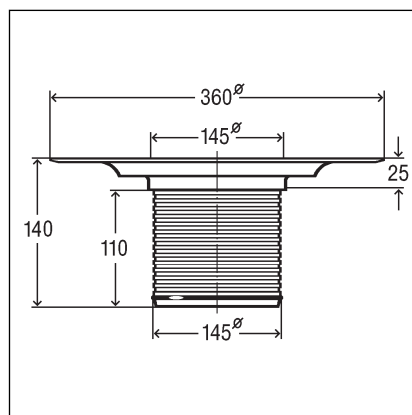

Fig. 4: Dimensional drawing for model 4994

3.1.3 Tools and materials

Required material

- Top with grate

3.2 Assembly

3.2.1 Mounting stacking element

Requirements

- The drain has been mounted and lined in accordance with the instructions for use.

- Remove yellow protective plug from the drain.

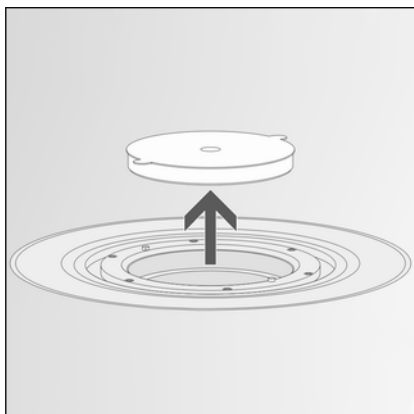

- Calculate the height of the floor construction from the edge in the inside of the drain up to the upper edge of the floor.

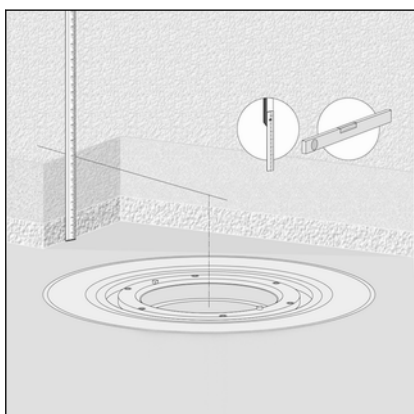

- Starting with the upper edge, transfer the measured height onto the stacking element.

- Cut the stacking element to the marked height.

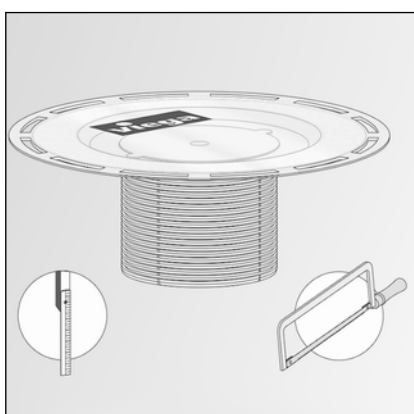

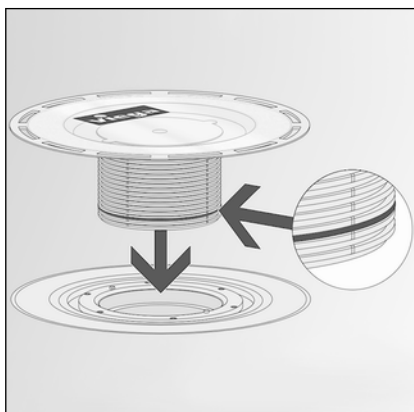

- Install backflow seal.
- Insert stacking element in drain.

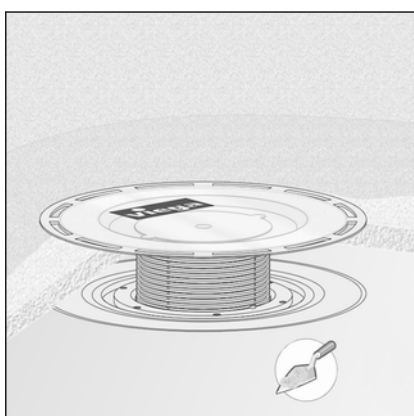

- Work the stacking element into the screed or floor covering.



NOTICE!
Product damage due to improper installation

If hollow spaces occur during the lining of the stacking element, leaks may occur when pressure is applied.

Inform the subsequent workers that the flange of the stacking element must be fully lined and that there must be no hollow spaces.

3.2.2 Sealing the drain



NOTICE!
Product damage due to improper installation

If hollow spaces occur during the lining of the flange, leaks may occur when pressure is applied.

Check the proper completion of the subsequent work.



Screed and floor tiles must be laid at an incline of 1–2 % in the direction of the drain.

Bonded sealing

Requirements:

- The flange is free of heavy soil.
- The complete surface of the flange is lined with material and undamaged.
- Remove protective foil.

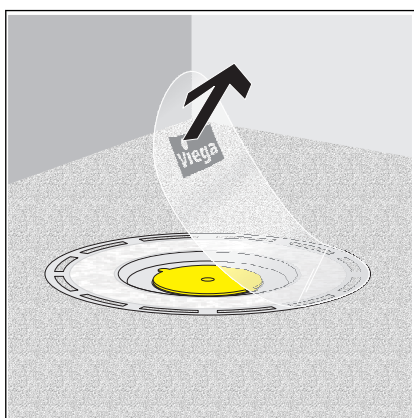

- Apply liquid foil onto the dry screed and spread onto the internal edge of the flange tile.

NOTICE! Observe the liquid foil manufacturer's instructions for use.

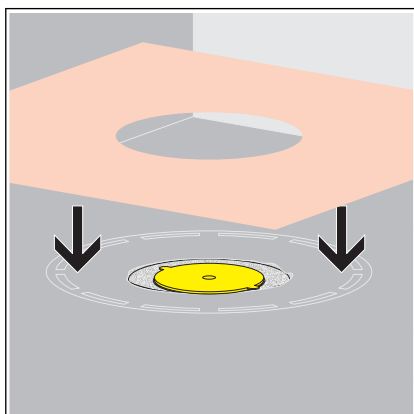

► Lay the sealing collar into the liquid foil.



► Apply second layer of liquid foil onto the sealing collar and, if necessary, onto the floor.

3.2.3 Mounting the top

If necessary, the top with the grate must still be mounted to finish off the mounting of the drain. Proceed as follows:

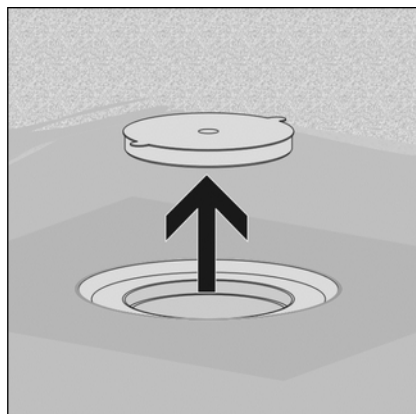

- Remove yellow protective plug.

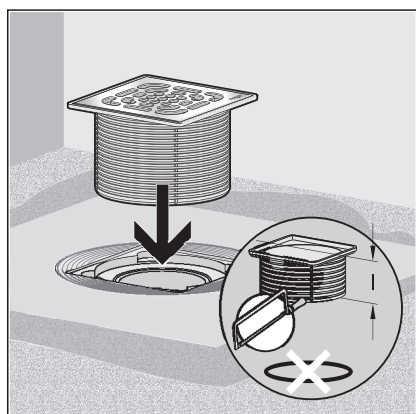

- Cut the top flush to length with the upper edge of the tiles.
- Insert top without backflow seal.

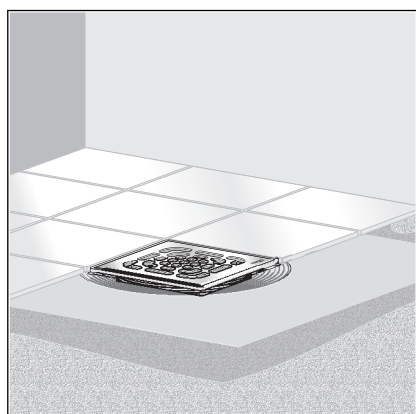

- Lay tiles. Keep gap between top and flange free from surface seal and tile adhesive.

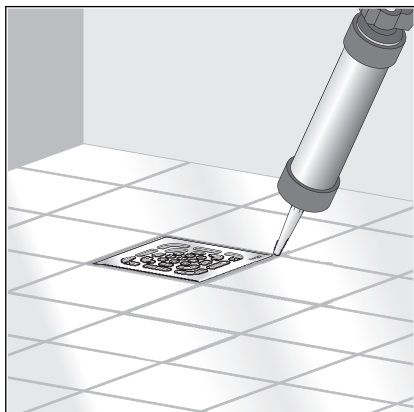

- Close the gap between grate and tiles with silicone.

3.3 Disposal

Separate the product and packaging materials (e. g. paper, metal, plastic or non-ferrous metals) and dispose of in accordance with valid national legal requirements.