

Seapress

Piping technology

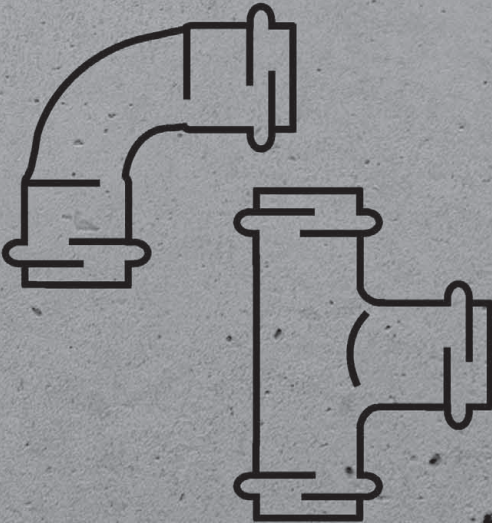

Press connectors made of the alloy CuNi10Fe1,6Mn. This alloy fulfils the requirements for seawater applications. Rigid and dimensionally stable for fast and clean installation of the main, manifold and connection pipelines.

Cold pressing in seconds with all the advantages that go with it. No soldered or welded connection points, therefore no risk of fire.

Dimensions

Standard sizes: d 15; 22; 28; 35; 42; 54

XL sizes: d 76.1; 88.9; 108.0

Areas of application in shipbuilding

Fire extinguisher systems

Sprinkler systems

Seawater cooling

Bilge and ballast systems

Seawater desalination systems

Use of press tools

The functional safety of the Viega press connector systems is primarily dependent on the perfect condition of the press tools and press machines used. For this reason, for the production of press connections, we recommend the use of Viega press tools and their regular inspection by authorised service points.

Technical data

Press connectors and components are constantly being optimised. If required, the current Z and installation dimensions can be obtained from the download area of the Viega homepage: viega.com

The Seapress system is certified from the following certifying bodies:



- Lloyd's Register



- DNV GL



- Registro Italiano Navale



- Bureau Veritas



- American Bureau of Shipping



- Class NK

INDEX

Elbows	4
T-pieces	6
Adapter pieces/adaptor elbows	8
Couplings	9
Reductions	10
Screw fittings	10
Flanges	11



GTIN-Code (Global Trade Item Number, previously EAN-Code)

The GTIN-Code composed out of the constant manufacturer number 4015211 and a six-digit article code - in this example 305 611. The exchange of the last six digits against the article code shows the GTIN-Code.

ELBOWS

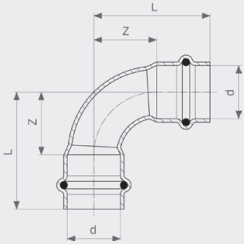

Seapress Elbow 90°
- CuNiFe
Model 0316

article	d	Z	L	weight
453 169	15	18	40	48
453 176	22	26	49	88
453 183	28	34	58	124
453 190	35	33	59	158
453 206	42	50	86	307
453 213	54	65	105	513

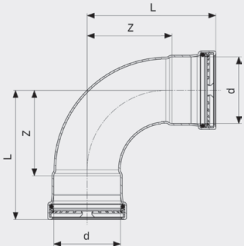

Seapress XL Elbow 90°
- CuNiFe
Model 0316XL

article	d	Z	L	weight
556 570	76.1	99	149	1295
556 563	88.9	114	164	1550
556 556	108.0	138	198	2719

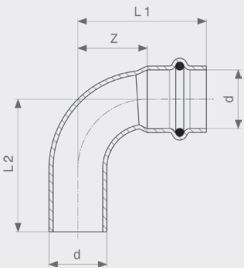

Seapress Elbow 90°
- CuNiFe
Model 0316.1

article	d	Z	L1	L2	weight
453 220	15	18	40	42	45
453 237	22	26	49	51	84
453 244	28	34	58	60	118
453 657	35	33	59	63	154
453 664	42	50	86	90	278
453 671	54	65	105	107	482

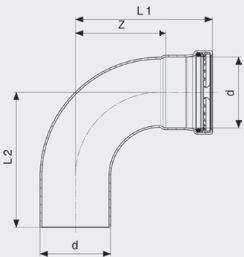

Seapress XL Elbow 90°
- CuNiFe
Model 0316.1XL

article	d	Z	L1	L2	weight
556 525	76.1	99	149	146	1148
556 532	88.9	114	164	162	1452
556 549	108.0	138	198	195	2563

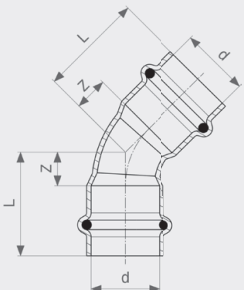

Seapress Elbow 45°
- CuNiFe
Model 0326

article	d	Z	L	weight
453 886	15	8	30	40
453 893	22	11	34	71
453 909	28	14	38	97
453 916	35	17	43	136
453 923	42	21	55	276
453 930	54	27	67	377

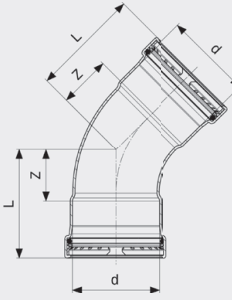

Seapress XL Elbow 45°
- CuNiFe
Model 0326XL

article	d	Z	L	weight
556 617	76.1	46	96	928
556 624	88.9	52	102	1100
556 631	108.0	61	121	1928

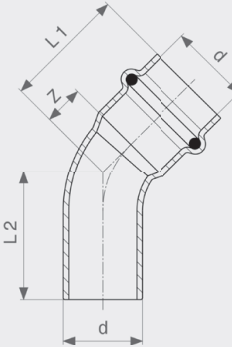

Seapress Elbow 45°
- CuNiFe
Model 0326.1

article	d	Z	L1	L2	weight
453 947	15	8	30	32	38
453 954	22	11	34	36	70
453 961	28	14	38	40	88
453 978	35	17	43	45	130
453 985	42	21	57	63	263
453 992	54	27	67	69	363

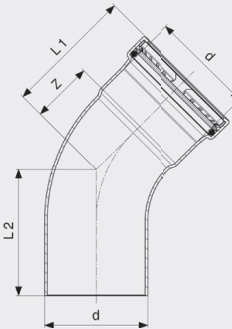

Seapress XL Elbow 45°
- CuNiFe
Model 0326.1XL

article	d	Z	L1	L2	weight
556 587	76.1	46	96	93	843
556 594	88.9	52	102	99	1075
556 600	108.0	61	121	119	1820

T-PIECES

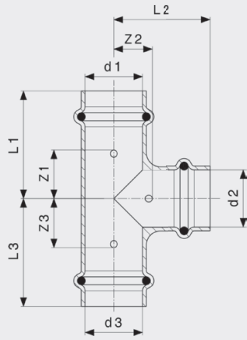

Seapress T-piece
- CuNiFe
Model 0318

article	d1	d2	d3	Z1	Z2	Z3	L1	L2	L3	weight
453 473	15	15	15	18	11	18	40	33	40	81
453 480	22	22	22	22	15	22	44	38	44	157
453 497	28	28	28	24	19	24	48	43	48	192
453 503	35	35	35	26	22	26	52	48	52	268
453 534	42	35	42	22	29	22	58	55	58	403
453 510	42	42	42	29	29	29	65	65	65	527
453 541	54	35	54	27	35	27	68	61	68	558
453 558	54	42	54	29	35	29	69	71	69	628
453 527	54	54	54	35	35	35	75	75	75	686

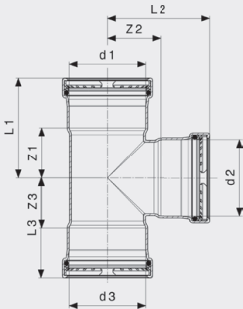

Seapress XL T-piece
- CuNiFe
Model 0318XL

article	d1	d2	d3	Z1	Z2	Z3	L1	L2	L3	weight
453 794	76.1	35	76.1	30	50	30	80	77	80	878
453 800	76.1	54	76.1	40	50	40	90	90	90	1050
556 228	76.1	76.1	76.1	50	52	50	100	102	100	1255
453 824	88.9	35	88.9	30	57	30	80	83	80	1011
453 831	88.9	54	88.9	40	57	40	90	98	90	1188
453 848	88.9	76.1	88.9	50	59	50	100	109	100	1445
556 235	88.9	88.9	88.9	57	59	57	107	109	107	1568
453 862	108.0	54	108.0	40	66	46	100	106	100	1783
453 879	108.0	76.1	108.0	52	68	52	112	118	112	2090
556 242	108.0	108.0	108.0	68	70	68	128	130	128	2605

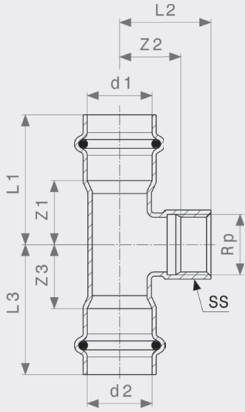

Seapress T-piece
- CuNiFe
Model 0317.2

article	d1	Rp	d2	Z1	Z2	Z3	L1	L2	L3	SS	weight
453 749	35	3/4	35	20	30	20	46	46	46	30	247
453 756	42	3/4	42	17	36	17	53	52	53	30	372
453 763	54	3/4	54	20	40	20	60	57	60	30	453

SS = wrench size

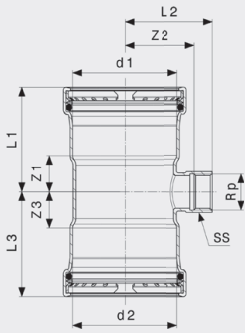

Seapress XL T-piece
- CuNiFe
Model 0317.2XL

article	d1	Rp	d2	Z1	Z2	Z3	L1	L2	L3	SS	weight
453 770	76.1	3/4	76.1	25	45	25	75	62	75	30	846

SS = wrench size

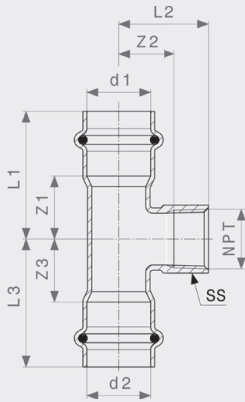

Seapress T-piece
- CuNiFe
Model 0317.5

article	d1	NPT	d2	Z1	Z2	Z3	L1	L2	L3	weight
461 072	35	3/4	35	20	32	20	46	46	46	254
461 089	42	3/4	42	17	38	17	53	52	53	384
461 096	54	3/4	54	20	42	20	60	57	60	519

ADAPTER PIECES/ADAPTER ELBOWS

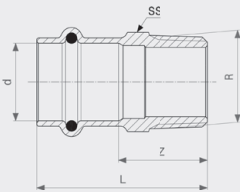

Seapress Adapter
- CuNiFe
Model 0311

article	d	R	Z	L	SS	weight
452 971	15	1/2	22	44	22	57
452 995	22	3/4	27	50	28	98
452 988	28	1	31	55	36	129
453 008	35	1 1/4	36	62	43	198
453 015	42	1 1/2	36	72	50	292
453 022	54	2	40	80	68	484

SS = wrench size

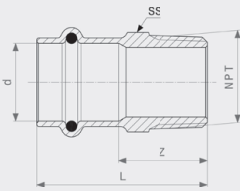

Seapress Adapter
- CuNiFe
Model 0311.5

article	d	NPT	Z	L	SS	weight
460 792	15	1/2	24	46	22	61
460 815	22	3/4	28	52	28	100
460 822	28	1	34	58	36	136
461 157	35	1 1/4	38	64	43	202
461 164	42	1 1/2	36	72	50	311
461 171	54	2	39	79	68	490

SS = wrench size

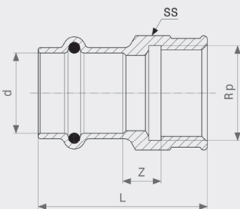

Seapress Adapter
- CuNiFe
Model 0312

article	d	Rp	Z	L	SS	weight
453 039	15	1/2	7	44	26	62
453 046	22	3/4	8	47	30	84
453 053	28	1	9	52	38	129
453 060	35	1 1/4	6	54	47	177
453 084	42	1 1/2	11	69	53	302
453 091	54	2	14	80	70	568

SS = wrench size

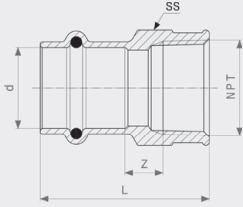

Seapress Adapter
- CuNiFe
Model 0312.5

article	d	NPT	Z	L	SS	weight
461 188	15	1/2	7	43	26	69
461 195	22	3/4	8	45	30	80
461 201	28	1	10	51	38	126
461 218	35	1 1/4	9	52	47	176
461 225	42	1 1/2	11	64	53	289
461 249	54	2	13	71	70	451

SS = wrench size

COUPLINGS

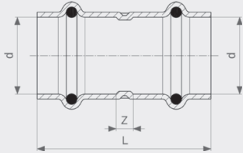

Seapress Coupling
- CuNiFe
Model 0315

article	d	Z	L	weight	Z*	L*
453 107	15	5	50	36		
453 114	22	10	56	64		
453 121	28	10	58	80		
453 138	35	10	62	109		
453 145	42	12	84	224		
453 152	54	4	84	262	12	92

Z* = previous version

L* = length of the previous version

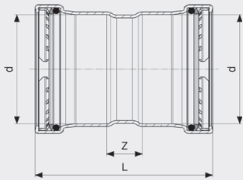

Seapress XL Coupling
- CuNiFe
Model 0315XL

article	d	Z	L	weight
556 495	76.1	25	125	705
556 501	88.9	25	125	782
556 518	108.0	27	147	1270

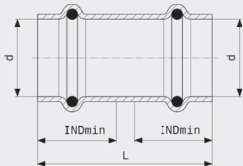

Seapress Sliding coupling
- CuNiFe
Model 0315.3

article	d	L	INDmin	weight
453 299	15	50	22	36
453 305	22	56	23	65
453 312	28	58	24	81
453 329	35	62	26	104
453 336	42	84	36	222
453 343	54	92	40	262

INDmin = insertion depth minimum

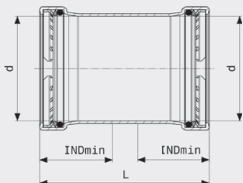

Seapress XL Sliding coupling
- CuNiFe
Model 0315.5XL

article	d	L	INDmin	weight
453 411	76.1	125	50	684
453 428	88.9	125	50	790
453 435	108.0	147	60	1273

INDmin = insertion depth minimum

REDUCTIONS

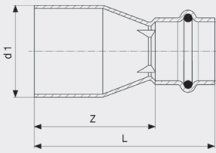

Seapress Reducer
- CuNiFe
Model 0315.1

article	d1	d2	Z	L	weight
452 810	22	15	36	58	42
452 827	28	22	36	59	61
452 834	35	22	46	69	83
452 841	35	28	39	63	84
453 251	42	28	63	87	130
453 268	42	35	56	82	136
453 275	54	35	71	97	180
453 282	54	42	65	101	247

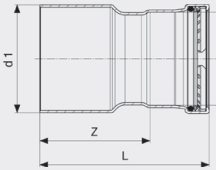

Seapress XL Reducer
- CuNiFe
Model 0315.1XL

article	d1	d2	Z	L
453 350	76.1	42	99	136
556 648	76.1	54	93	133
453 374	88.9	54	99	140
556 198	88.9	76.1	82	140
556 204	108.0	76.1	111	161
556 211	108.0	88.9	104	154

SCREW FITTINGS

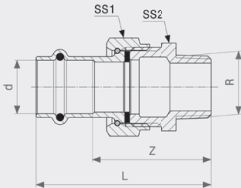

Seapress Adapter union
- CuNiFe
Model 0365

article	d	R	Z	L	SS1	SS2	weight
477 172	15	1/2	44	66	30	27	133
477 189	22	1/2	48	71	37	34	195
477 196	22	3/4	49	72	37	34	206
477 202	28	1	57	80	46	44	325
477 219	35	1 1/4	62	88	53	50	422
534 684	42	1 1/2	66	101	60	55	617

SS = Spanner size
SS = spanner size

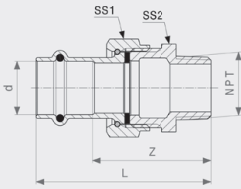

Seapress Adapter union
- CuNiFe
Model 0365.5

article	d	NPT	Z	L	SS1	SS2	weight
477 226	15	1/2	44	66	30	27	134
477 233	22	1/2	48	72	37	34	195
477 240	22	3/4	50	73	37	34	208
477 264	28	1	58	81	46	44	319
477 257	35	1 1/4	61	86	53	50	420
534 691	42	1 1/2	68	104	60	55	626

SS = Spanner size
SS = spanner size

FLANGES

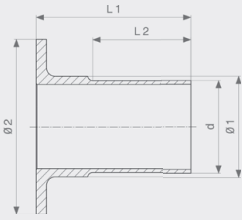

Seapress Flange
- CuNiFe
Model 0359.3

article	d	Ø1	Ø2	L1	L2
454 067	22	27	58	66	38
454 074	28	32	68	70	42
454 081	35	40	78	75	47
454 098	42	47	88	88	55
454 104	54	59	102	91	58

Ø = diameter

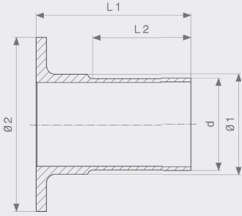

Seapress XL Flange
- CuNiFe
Model 0359.3XL

article	d	Ø1	Ø2	L1	L2
454 111	76.1	78	122	100	67
454 128	88.9	91	138	100	62
454 135	108.0	110	158	110	72

Ø = diameter

order code	page	order code	page	order code	page	order code	page	order code	page
452 810	10	453 930	4						
452 827	10	453 947	5						
452 834	10	453 954	5						
452 841	10	453 961	5						
452 971	8	453 978	5						
452 988	8	453 985	5						
452 995	8	453 992	5						
453 008	8	454 067	11						
453 015	8	454 074	11						
453 022	8	454 081	11						
453 039	8	454 098	11						
453 046	8	454 104	11						
453 053	8	454 111	11						
453 060	8	454 128	11						
453 084	8	454 135	11						
453 091	8	460 792	8						
453 107	9	460 815	8						
453 114	9	460 822	8						
453 121	9	461 072	8						
453 138	9	461 089	8						
453 145	9	461 096	8						
453 152	9	461 157	8						
453 169	4	461 164	8						
453 176	4	461 171	8						
453 183	4	461 188	9						
453 190	4	461 195	9						
453 206	4	461 201	9						
453 213	4	461 218	9						
453 220	4	461 225	9						
453 237	4	461 249	9						
453 244	4	477 172	10						
453 251	10	477 189	10						
453 268	10	477 196	10						
453 275	10	477 202	10						
453 282	10	477 219	10						
453 299	9	477 226	10						
453 305	9	477 233	10						
453 312	9	477 240	10						
453 329	9	477 257	10						
453 336	9	477 264	10						
453 343	9	534 684	10						
453 350	10	534 691	10						
453 374	10	556 198	10						
453 411	9	556 204	10						
453 428	9	556 211	10						
453 435	9	556 228	6						
453 473	6	556 235	6						
453 480	6	556 242	6						
453 497	6	556 495	9						
453 503	6	556 501	9						
453 510	6	556 518	9						
453 527	6	556 525	4						
453 534	6	556 532	4						
453 541	6	556 549	4						
453 558	6	556 556	4						
453 657	4	556 563	4						
453 664	4	556 570	4						
453 671	4	556 587	5						
453 749	7	556 594	5						
453 756	7	556 600	5						
453 763	7	556 617	5						
453 770	7	556 624	5						
453 794	6	556 631	5						
453 800	6	556 648	10						
453 824	6								
453 831	6								
453 848	6								
453 862	6								
453 879	6								
453 886	4								
453 893	4								
453 909	4								
453 916	4								
453 923	4								

model no.	page	model no.	page	model no.	page	model no.	page	model no.	page
0311	8								
0311.5	8								
0312	8								
0312.5	9								
0315	9								
0315.1	10								
0315.1XL	10								
0315.3	9								
0315.5XL	9								
0315XL	9								
0316	4								
0316.1	4								
0316.1XL	4								
0316XL	4								
0317.2	7								
0317.2XL	7								
0317.5	8								
0318	6								
0318XL	6								
0326	4								
0326.1	5								
0326.1XL	5								
0326XL	5								
0359.3	11								
0359.3XL	11								
0365	10								
0365.5	10								