

Prestabo LF with SC-Contur, labs-free

Piping technology
steel, labs-free

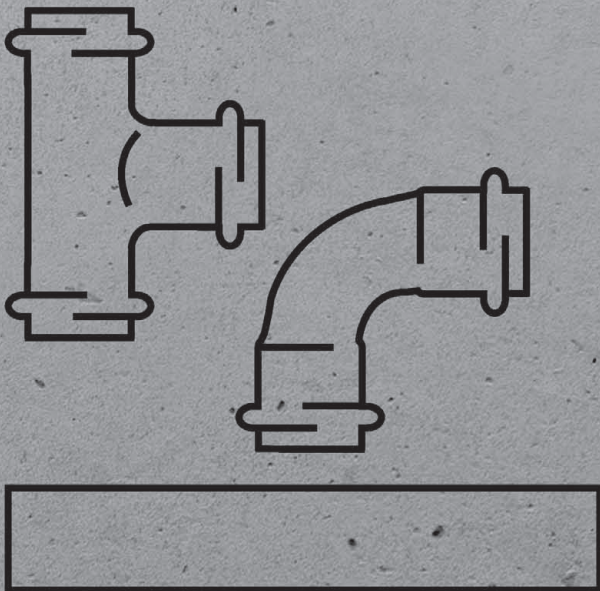

Press connector system (labs-free) with press connectors and pipes made of non-alloy steel 1.0308 (E235), in acc. with DIN EN 10305-3, externally galvanised with a zinc layer thickness of 8–15 µm (blue chromatised)

The press connector system Prestabo LF is free from paint-wetting impairment substances (labs) such as silicone, fat, oil etc. and is therefore especially suitable for the use of pipeline installations in paint shops.

Press connectors

All sizes with SC-Contour – connections, which remain unpressed become visible when the system is filled. The SC-Contour is certified and fulfils the requirements of DVGW worksheet W 534, point 12.14, connectors with forced leakage. During leakage tests with water, Viega guarantees the identification of unpressed connections in the pressure range 0.1 MPa–0.65 MPa, in the case of a dry leakage test with compressed air or noble gases from 22 hPa–0.3 MPa.

Marking

Blue/red point on the press connection

Red symbol (to prevent confusion with Sanpress Inox (stainless steel) articles) »Not for drinking water installations«



Sealing elements

EPDM

Dimensions/Material

Standard sizes: d 12; 15; 18; 22; 28; 35; 42; 54 made of steel
XL sizes: 64.0; 76.1; 88.9; 108.0 made of steel

Prestabo system pipe versions

- System pipe made of non-alloy steel with the material number 1.0308 (E235), in acc. with DIN EN 10305-3 externally zinc plated galvanised.
- System pipe made of non-alloy steel with the material number 1.0215 (E220), in acc. with DIN EN 10305 internally and externally sendzimir galvanised.

Areas of application

Heating systems
Industrial and plant engineering
Sprinkler units (sendzimir galvanised pipe)
Compressed air units (sendzimir galvanised pipe)
Solar systems
Air-conditioning systems

Use of the system for application areas and media other than those described here must be agreed with Viega Service Center.

Operating conditions with EPDM sealing element

- Operating temperature max. 110 °C
- Operating pressure max. 1.6 MPa (PN 16)

Use of press tools

The functional safety of the Viega press connector systems is primarily dependent on the perfect condition of the press tools and press machines used. For this reason, for the production of press connections, we recommend the use of Viega press tools and their regular inspection by authorised service points.

Technical data

Press connectors and components are constantly being optimised. If required, the current Z and installation dimensions can be obtained from the download area of the Viega homepage: viega.com

Storage and transport

To ensure the impeccable quality of the Prestabo steel pipes, the following points should be observed during transport and storage:

- Packing and protective foil (only with PP coated pipes) should not be removed until immediately before use.
- The pipe ends must be closed with protective caps when delivered.
- Do not store the pipes directly on the bare floor.
- Do not stick any protective foils or plastics to the pipe surfaces.
- When loading and unloading, do not pull the steel pipes over the truck sill.

Protection against external corrosion

Prestabo pipes and connectors are protected by external galvanisation. In case of contact with dampness (condensation, precipitation during the construction phase, plaster and splash water etc.) or corrosive building materials (surfacers, levelling screed etc.), however this layer of zinc cannot provide permanent protection against external corrosion. The following protective measures are recommended:

- Use of closed-cell insulating tubes with professional sealing of all abutting and cut edges using a suitable filler.
- Damp-proofing of the laid pipe through separating foil in the floor construction.
- Installing pipes outside areas at risk of moisture.
- Visible radiator connections rising from the floors should be avoided if floors will be frequently cleaned with water and/or cleaning agents/disinfectants, for example in retirement homes and care homes as well as hospitals. Wall connections make cleaning easier and also exclude any additional risk of corrosion.
- If the radiator connections do come from the floor, professional corrosion protection and professional sealing of the joints must be ensured. If not, there is a possibility that the cleaning water will penetrate, which will moisten the insulation and present the risk of corrosion.

If the measures in the examples above fail to provide permanent protection against dampness or the areas of use are connected with special requirements, e.g. in cooling circuits, complete external corrosion protection, which reliably prevents influences that lead to corrosion must be applied.

Further detailed information and examples of use can be found in the practical handbook and on the internet.

INDEX

Elbows	4
T-pieces	6
Adapter pieces/adaptor elbows	9
Couplings	9
Reductions	10
Screw fittings	11
Caps	12
Flanges	12



GTIN-Code (Global Trade Item Number, previously EAN-Code)

The GTIN-Code composed out of the constant manufacturer number 4015211 and a six-digit article code - in this example 305 611. The exchange of the last six digits against the article code shows the GTIN-Code.

ELBOWS

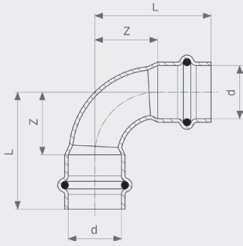

Prestabo LF Elbow 90°
- galvanised non-alloyed steel
Model 1116LF

article	VdS	d	Z	L
716 066		15	16	38
716 080		18	18	40
716 127	✓	22	26	49
716 165	✓	28	34	58
716 189	✓	35	32	59
716 202	✓	42	50	87
716 226	✓	54	65	105

VdS = VdS certification

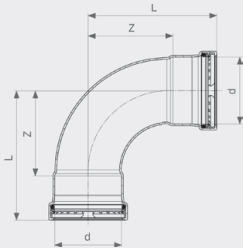

Prestabo XL LF Elbow 90°
- galvanised non-alloyed steel
Model 1116XLLF

article	VdS	d	L	Z
716 240	✓	64.0	126	84
716 318	✓	76.1	149	99
716 325	✓	88.9	164	114
716 332	✓	108.0	198	138

VdS = VdS certification

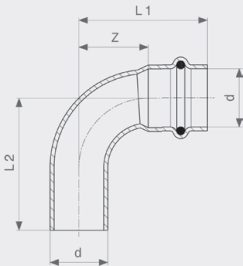

Prestabo LF Elbow 90°
- galvanised non-alloyed steel
Model 1116.1LF

article	VdS	d	Z	L1	L2
715 779		15	16	38	40
715 786		18	18	40	42
715 793	✓	22	26	49	50
715 809	✓	28	34	58	59
715 816	✓	35	32	59	62
715 823	✓	42	50	87	88
715 830	✓	54	65	105	107

VdS = VdS certification

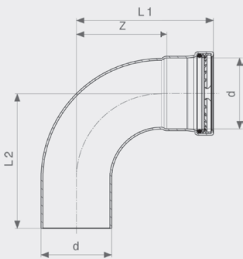

Prestabo XL LF Elbow 90°
- galvanised non-alloyed steel
Model 1116.1XLLF

article	VdS	d	Z	L1	L2
715 847	✓	64.0	84	126	126
715 854	✓	76.1	99	149	146
715 861	✓	88.9	114	164	162
715 878	✓	108.0	138	198	195

VdS = VdS certification

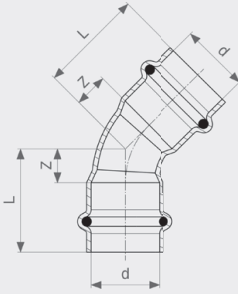

Prestabo LF Elbow 45°
- galvanised non-alloyed steel
Model 1126LF

article	VdS	d	Z	L
716 141		15	7	29
716 158		18	7	29
716 172	✓	22	11	34
716 196	✓	28	14	38
716 219	✓	35	15	41
716 233	✓	42	21	57
716 257	✓	54	27	67

VdS = VdS certification

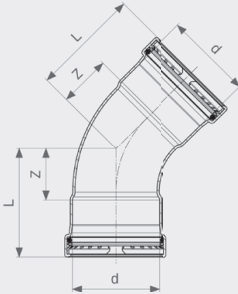

Prestabo XL LF Elbow 45°
- galvanised non-alloyed steel
Model 1126XLLF

article	VdS	d	Z	L
716 264	✓	64.0	39	82
716 271	✓	76.1	46	96
716 288	✓	88.9	52	102
716 295	✓	108.0	61	121

VdS = VdS certification

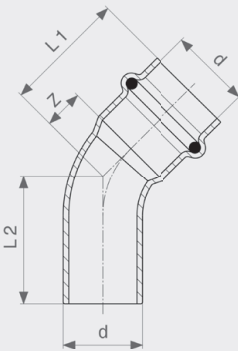

Prestabo LF Elbow 45°
- galvanised non-alloyed steel
Model 1126.1LF

article	VdS	d	Z	L1	L2
716 004		15	7	29	29
716 011		18	7	29	30
716 028	✓	22	11	34	35
716 035	✓	28	14	38	39
716 042	✓	35	15	41	42
716 059	✓	42	21	57	59
716 073	✓	54	27	67	69

VdS = VdS certification

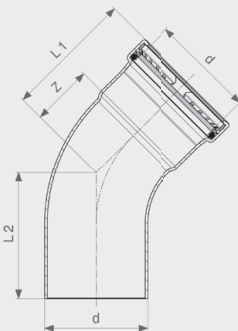

Prestabo XL LF Elbow 45°
- galvanised non-alloyed steel
Model 1126.1XLLF

article	VdS	d	Z	L1	L2
716 097	✓	64.0	39	82	82
716 103	✓	76.1	46	96	93
716 110	✓	88.9	52	102	99
716 134	✓	108.0	61	121	119

VdS = VdS certification

T-PIECES

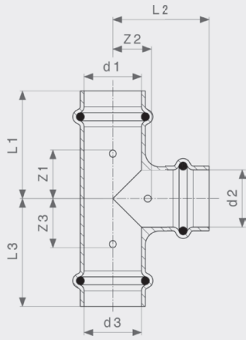

Prestabo LF T-piece
 - galvanised non-alloyed steel
Model 1118LF

article	VdS	d1	d2	d3	Z1	Z2	Z3	L1	L2	L3
716 479		15	15	15	19	22	19	41	44	41
716 585		18	15	18	21	23	21	43	45	43
716 486		18	18	18	21	23	21	43	45	43
716 592		22	15	22	22	25	22	45	47	45
716 608		22	18	22	22	25	22	45	47	45
716 493	✓	22	22	22	24	26	24	47	50	47
716 615		28	15	28	21	29	21	45	51	45
716 622		28	18	28	21	29	21	45	51	45
716 639	✓	28	22	28	23	30	23	47	54	47
716 509	✓	28	28	28	28	29	28	52	53	52
716 646		35	18	35	19	32	19	45	54	45
716 653	✓	35	22	35	21	34	21	47	57	47
716 660	✓	35	28	35	26	33	26	53	57	53
716 516	✓	35	35	35	26	26	26	53	53	53
716 677		42	18	42	19	36	19	55	58	55
716 684	✓	42	22	42	19	38	19	55	60	55
716 691	✓	42	28	42	25	36	25	61	60	61
716 707	✓	42	35	42	25	30	25	61	56	61
716 523	✓	42	42	42	32	32	32	68	68	68
716 714	✓	54	22	54	18	44	18	58	66	58
716 721	✓	54	28	54	21	42	21	61	66	61
716 738	✓	54	35	54	25	36	25	65	62	65
716 745	✓	54	42	54	29	38	29	69	74	69
716 530	✓	54	54	54	39	39	39	79	79	79

VdS = VdS certification

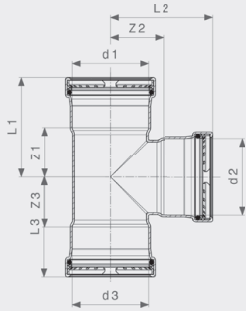

Prestabo XL LF T-piece
- galvanised non-alloyed steel
Model 1118XLLF

article	VdS	d1	d2	d3	Z1	Z2	Z3	L1	L2	L3
715 359	✓	64.0	28	64.0	27	41	27	70	65	70
715 366	✓	64.0	35	64.0	32	42	32	74	68	74
715 373	✓	64.0	42	64.0	35	44	35	78	80	78
715 380	✓	64.0	54	64.0	41	44	41	84	84	84
716 547	✓	64.0	64.0	64.0	46	48	46	89	91	89
715 397	✓	76.1	28	76.1	26	47	26	76	71	76
715 403	✓	76.1	35	76.1	30	48	30	80	74	80
715 410	✓	76.1	42	76.1	34	49	34	84	86	84
715 427	✓	76.1	54	76.1	40	51	40	90	91	90
715 434	✓	76.1	64.0	76.1	50	53	50	100	96	100
716 554	✓	76.1	76.1	76.1	50	55	50	100	105	100
715 441	✓	88.9	28	88.9	26	54	26	76	78	76
715 885	✓	88.9	35	88.9	30	54	30	80	81	80
715 892	✓	88.9	42	88.9	34	56	34	84	92	84
715 908	✓	88.9	54	88.9	40	57	40	90	97	90
715 915	✓	88.9	64.0	88.9	50	60	50	100	103	100
715 922	✓	88.9	76.1	88.9	50	61	50	100	111	100
716 561	✓	88.9	88.9	88.9	57	59	57	107	109	107
715 939	✓	108.0	28	108.0	26	63	26	86	87	86
715 946	✓	108.0	35	108.0	30	64	30	90	90	90
715 953	✓	108.0	42	108.0	34	66	34	94	102	94
715 960	✓	108.0	54	108.0	40	67	40	100	107	100
715 977	✓	108.0	64.0	108.0	50	70	50	110	112	110
715 984	✓	108.0	76.1	108.0	50	71	50	110	121	110
715 991	✓	108.0	88.9	108.0	57	69	57	117	119	117
716 578	✓	108.0	108.0	108.0	66	69	66	126	129	126

VdS = VdS certification

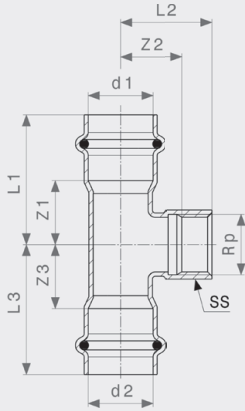

Prestabo LF T-piece
- galvanised non-alloyed steel
Model 1117.2LF

article	VdS	d1	Rp	d2	Z1	Z2	Z3	L1	L2	L3	SS
716 349		15	1/2	15	19	14	19	41	29	41	24
716 356		18	1/2	18	21	15	21	43	30	43	24
716 363	✓	22	1/2	22	22	17	22	45	32	45	24
716 394	✓	28	1/2	28	21	21	21	45	36	45	24
716 370	✓	28	1	28	28	20	28	52	40	52	36
716 400	✓	35	1/2	35	19	24	19	45	40	45	24
716 417	✓	42	1/2	42	19	28	19	55	43	55	24
716 424	✓	54	1/2	54	18	34	18	58	49	58	24

VdS = VdS certification
SS = spanner size

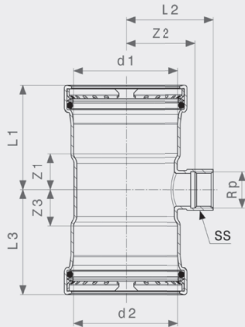

Prestabo XL LF T-piece
- galvanised non-alloyed steel
Model 1117.2XLLF

article	VdS	d1	Rp	d2	Z1	Z2	Z3	L1	L2	L3	SS
716 431	✓	64.0	3/4	64.0	27	39	27	70	55	70	30
716 448	✓	76.1	3/4	76.1	26	45	26	76	62	76	30
716 455	✓	88.9	3/4	88.9	26	52	26	76	68	76	30
716 462	✓	108.0	3/4	108.0	26	61	26	86	78	86	30

VdS = VdS certification
SS = spanner size

ADAPTER PIECES/ADAPTER ELBOWS

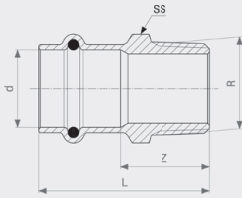

Prestabo LF Adapter
- galvanised non-alloyed steel
Model 1111LF

article	d	R	Z	L	SS
714 932	15	1/2	24	46	24
714 949	18	1/2	24	27	46
714 963	18	3/4	27	49	27
714 987	22	1/2	25	48	27
714 994	22	3/4	26	49	27
714 970	22	1	31	34	54
715 014	28	3/4	28	52	34
715 007	28	1	30	54	34
715 021	35	1	34	60	36
715 038	35	1 1/4	36	62	46
715 045	42	1 1/2	36	72	55
715 052	54	2	42	82	70

SS = spanner size

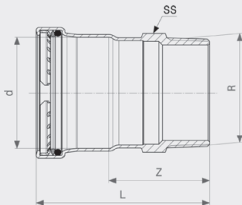

Prestabo XL LF Adapter
- galvanised non-alloyed steel
Model 1111XLLF

article	VdS	d	R	Z	L	SS
715 069	✓	64.0	2 1/2	65	108	60
715 076	✓	76.1	2 1/2	64	114	80
715 083	✓	88.9	3	68	118	90
715 090	✓	108.0	4	74	134	114

VdS = VdS certification
SS = spanner size

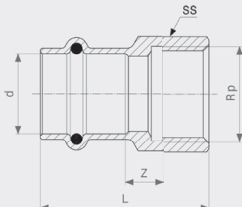

Prestabo LF Adapter
- galvanised non-alloyed steel
Model 1112LF

article	VdS	d	Rp	Z	L	SS
715 106		15	1/2	4	41	24
715 113		18	1/2	4	41	27
715 120		18	3/4	6	44	34
715 137	✓	22	1/2	3	41	27
715 144	✓	22	3/4	6	45	34
715 168	✓	28	3/4	3	44	38
715 151	✓	28	1	5	48	38
715 175	✓	35	1 1/4	5	52	50
715 182	✓	42	1 1/4	5	63	55
715 199	✓	54	2	6	72	70

VdS = VdS certification
SS = spanner size

COUPLINGS

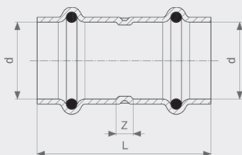

Prestabo LF Coupling
- galvanised non-alloyed steel
Model 1115LF

article	VdS	d	Z	L
715 663		15	12	56
715 670		18	11	55
715 687	✓	22	12	58
715 694	✓	28	12	60
715 700	✓	35	12	64
715 717	✓	42	12	84
715 724	✓	54	12	92

VdS = VdS certification

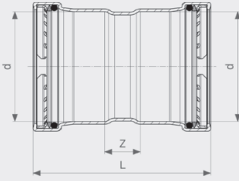

Prestabo XL LF Coupling
- galvanised non-alloyed steel
Model 1115XLLF

article	VdS	d	Z	L
715 731	✓	64.0	24	110
715 748	✓	76.1	25	125
715 755	✓	88.9	25	125
715 762	✓	108.0	25	145

VdS = VdS certification

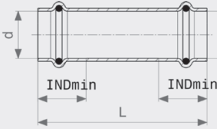

Prestabo LF Sliding coupling
- galvanised non-alloyed steel
Model 1115.5LF

article	VdS	d	L	INDmin
715 557		15	80	22
715 564		18	80	22
715 571	✓	22	80	23
715 588	✓	28	96	24
715 595	✓	35	106	26
715 601	✓	42	120	36
715 618	✓	54	136	40

VdS = VdS certification

INDmin = insertion depth minimum

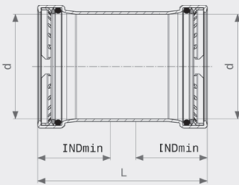

Prestabo XL LF Sliding coupling
- galvanised non-alloyed steel
Model 1115.5XLLF

article	VdS	d	L	INDmin
715 625	✓	64.0	110	43
715 632	✓	76.1	125	50
715 649	✓	88.9	125	50
715 656	✓	108.0	145	60

VdS = VdS certification

INDmin = insertion depth minimum

REDUCTIONS

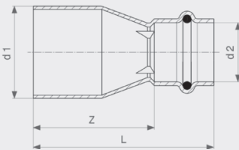

Prestabo LF Reducer
- galvanised non-alloyed steel
Model 1115.1LF

article	VdS	d1	d2	Z	L
715 205		18	15	30	52
715 212		22	15	35	57
715 229		22	18	37	59
715 236		28	15	50	72
715 243		28	18	47	69
715 250	✓	28	22	42	64
715 267	✓	35	22	50	74
715 274	✓	35	28	43	67
715 281	✓	42	22	65	88
715 298	✓	42	28	66	90
715 304	✓	42	35	54	80
715 311	✓	54	28	85	109
715 328	✓	54	35	81	107
715 335	✓	54	42	65	101

VdS = VdS certification

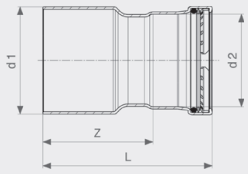

Prestabo XL LF Reducer
- galvanised non-alloyed steel
Model 1115.1XLLF

article	VdS	d1	d2	Z	L
715 342	✓	64.0	54	71	110
715 465	✓	76.1	54	83	123
715 472	✓	76.1	64.0	82	125
715 489	✓	88.9	54	90	130
715 496	✓	88.9	64.0	89	132
715 502	✓	88.9	76.1	82	132
715 519	✓	108.0	54	110	150
715 526	✓	108.0	64.0	109	152
715 533	✓	108.0	76.1	101	151
715 540	✓	108.0	88.9	95	145

VdS = VdS certification

SCREW FITTINGS

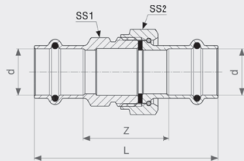

Prestabo LF Screw fitting
- galvanised non-alloyed steel
Model 1160LF

article	VdS	d	Z	L	SS1	SS2
716 929		15	33	77	30	30
716 936		18	34	78	30	30
716 943	✓	22	38	84	36	37
716 950	✓	28	42	90	46	46
716 967	✓	35	42	94	50	53
716 974	✓	42	43	115	55	60
716 981	✓	54	53	133	70	78

VdS = VdS certification

SS = spanner size

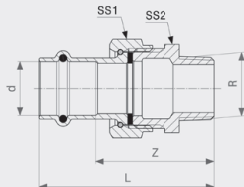

Prestabo LF Adapter union
- galvanised non-alloyed steel
Model 1165LF

article	VdS	d	R	Z	L	SS1	SS2
717 100		15	1/2	45	67	30	27
717 117	✓	22	3/4	54	76	30	27
717 124	✓	28	1	62	86	37	34
717 131	✓	35	1 1/4	58	84	53	50
717 148	✓	42	1 1/2	59	95	60	55
717 155	✓	54	2	69	109	78	72

VdS = VdS certification

SS = spanner size

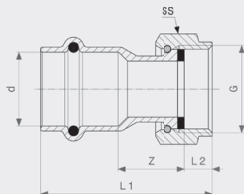

Prestabo LF Connection screw fitting
- galvanised non-alloyed steel
Model 1163LF

article	VdS	d	G	Z	L1	L2	SS
716 998		15	3/4	12	42	8	30
717 001		18	3/4	14	44	8	30
717 032	✓	22	3/4	19	50	8	30
717 018	✓	22	1	12	44	8	37
717 049	✓	28	1 1/4	14	48	10	46
717 056	✓	35	1 1/2	12	49	10	53
717 063	✓	42	1 3/4	12	58	10	60
717 070	✓	42	2	20	70	14	66
717 094	✓	54	2 3/8	15	68	12	78
717 087	✓	54	2 1/2	16	72	16	84

VdS = VdS certification

SS = spanner size

CAPS

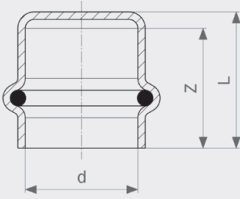

Prestabo LF Cap
- galvanised non-alloyed steel
Model 1156LF

article	VdS	d	Z	L
716 301		15	22	26
716 752		18	22	26
716 769	✓	22	24	26
716 776	✓	28	25	28
716 783	✓	35	26	30
716 790	✓	42	36	40
716 806	✓	54	40	44

VdS = VdS certification

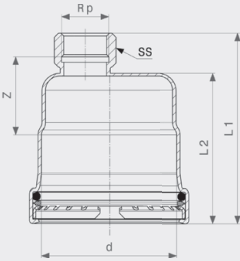

Prestabo XL LF Cap
- galvanised non-alloyed steel
Model 1156XLLF

article	VdS	d	Rp	Z	L1	L2	SS
716 813	✓	64.0	¼	39	99	78	30
716 820	✓	76.1	¼	39	105	84	30
716 837	✓	88.9	¼	39	105	84	30
716 844	✓	108.0	¼	39	115	94	30

VdS = VdS certification
SS = spanner size

FLANGES

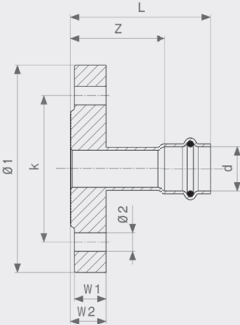

Prestabo LF Flange adapter
- galvanised non-alloyed steel
Model 1159LF

article	VdS	DN	d	Z	L	W1	W2	Ø1	k	Ø2	n
716 851	✓	32	35	44	70	16	18	140	100	18	4
716 868	✓	40	42	57	93	16	18	150	110	18	4
716 875	✓	50	54	57	97	16	18	165	125	18	4

VdS = VdS certification
Ø = diameter
k = bolt circle diameter
Ø = diameter
n = number of holes

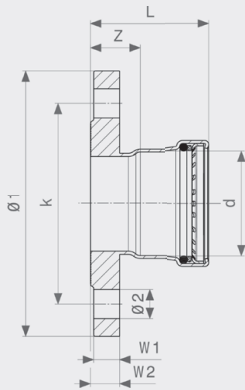

Prestabo XL LF Flange adapter
 - galvanised non-alloyed steel
Model 1159XLLF

article	VdS	DN	d	Z	L	W1	W2	Ø1	k	Ø2	n
716 882	✓	65	64.0	31	74	16	18	185	145	18	8
716 899	✓	65	76.1	30	80	16	18	185	145	18	8
716 905	✓	80	88.9	31	81	18	20	200	160	18	8
716 912	✓	100	108.0	32	92	18	20	220	180	18	8

VdS = VdS certification
 Ø = diameter
 k = bolt circle diameter
 Ø = diameter
 n = number of holes

order code	page	order code	page	order code	page	order code	page	order code	page
714 932	9	715 694	9	716 448	8				
714 949	9	715 700	9	716 455	8				
714 963	9	715 717	9	716 462	8				
714 970	9	715 724	9	716 479	6				
714 987	9	715 731	10	716 486	6				
714 994	9	715 748	10	716 493	6				
715 007	9	715 755	10	716 509	6				
715 014	9	715 762	10	716 516	6				
715 021	9	715 779	4	716 523	6				
715 038	9	715 786	4	716 530	6				
715 045	9	715 793	4	716 547	7				
715 052	9	715 809	4	716 554	7				
715 069	9	715 816	4	716 561	7				
715 076	9	715 823	4	716 578	7				
715 083	9	715 830	4	716 585	6				
715 090	9	715 847	4	716 592	6				
715 106	9	715 854	4	716 608	6				
715 113	9	715 861	4	716 615	6				
715 120	9	715 878	4	716 622	6				
715 137	9	715 885	7	716 639	6				
715 144	9	715 892	7	716 646	6				
715 151	9	715 908	7	716 653	6				
715 168	9	715 915	7	716 660	6				
715 175	9	715 922	7	716 677	6				
715 182	9	715 939	7	716 684	6				
715 199	9	715 946	7	716 691	6				
715 205	10	715 953	7	716 707	6				
715 212	10	715 960	7	716 714	6				
715 229	10	715 977	7	716 721	6				
715 236	10	715 984	7	716 738	6				
715 243	10	715 991	7	716 745	6				
715 250	10	716 004	5	716 752	12				
715 267	10	716 011	5	716 769	12				
715 274	10	716 028	5	716 776	12				
715 281	10	716 035	5	716 783	12				
715 298	10	716 042	5	716 790	12				
715 304	10	716 059	5	716 806	12				
715 311	10	716 066	4	716 813	12				
715 328	10	716 073	5	716 820	12				
715 335	10	716 080	4	716 837	12				
715 342	11	716 097	5	716 844	12				
715 359	7	716 103	5	716 851	12				
715 366	7	716 110	5	716 868	12				
715 373	7	716 127	4	716 875	12				
715 380	7	716 134	5	716 882	13				
715 397	7	716 141	5	716 899	13				
715 403	7	716 158	5	716 905	13				
715 410	7	716 165	4	716 912	13				
715 427	7	716 172	5	716 929	11				
715 434	7	716 189	4	716 936	11				
715 441	7	716 196	5	716 943	11				
715 465	11	716 202	4	716 950	11				
715 472	11	716 219	5	716 967	11				
715 489	11	716 226	4	716 974	11				
715 496	11	716 233	5	716 981	11				
715 502	11	716 240	4	716 998	11				
715 519	11	716 257	5	717 001	11				
715 526	11	716 264	5	717 018	11				
715 533	11	716 271	5	717 032	11				
715 540	11	716 288	5	717 049	11				
715 557	10	716 295	5	717 056	11				
715 564	10	716 301	12	717 063	11				
715 571	10	716 318	4	717 070	11				
715 588	10	716 325	4	717 087	11				
715 595	10	716 332	4	717 094	11				
715 601	10	716 349	8	717 100	11				
715 618	10	716 356	8	717 117	11				
715 625	10	716 363	8	717 124	11				
715 632	10	716 370	8	717 131	11				
715 649	10	716 394	8	717 148	11				
715 656	10	716 400	8	717 155	11				
715 663	9	716 417	8						
715 670	9	716 424	8						
715 687	9	716 431	8						

model no.	page	model no.	page	model no.	page	model no.	page	model no.	page
1111LF	9								
1111XLLF	9								
1112LF	9								
1115.1LF	10								
1115.1XLLF	11								
1115.5LF	10								
1115.5XLLF	10								
1115LF	9								
1115XLLF	10								
1116.1LF	4								
1116.1XLLF	4								
1116LF	4								
1116XLLF	4								
1117.2LF	8								
1117.2XLLF	8								
1118LF	6								
1118XLLF	7								
1126.1LF	5								
1126.1XLLF	5								
1126LF	5								
1126XLLF	5								
1156LF	12								
1156XLLF	12								
1159LF	12								
1159XLLF	13								
1160LF	11								
1163LF	11								
1165LF	11								