

Prestabo with SC-Contur

Piping technology
steel

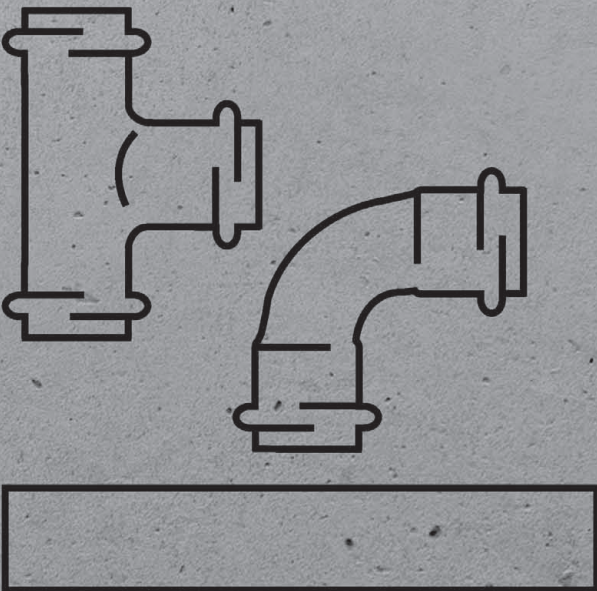

Press connector systems with press connectors and pipes made of non-alloy steel 1.0308 (E235), in acc. with EN 10305-3, externally galvanised with a zinc layer thickness of 8–15 µm (blue chromatised).

Press connectors

All sizes with SC-Contur – connections, which remain unpressed become visible when the system is filled. The SC-Contur is certified and fulfils the requirements of DVGW worksheet W 534, point 12.14, connectors with forced leakage. During leakage tests with water, Viega guarantees the identification of unpressed connections in the pressure range 0.1 MPa–0.65 MPa, in the case of a dry leakage test with compressed air or noble gases from 22 hPa–0.3 MPa.

Marking

Red symbol (to prevent confusion with Sanpress Inox (stainless steel) articles) »Not for drinking water installations«



Sealing elements

EPDM

Dimensions/Material

Standard sizes: d 12; 15; 18; 22; 28; 35; 42; 54 made of steel
XL sizes: 64.0; 76.1; 88.9; 108.0 made of steel

Press system pipe versions

- System pipe made of non-alloy steel with the material number 1.0308 (E235), in acc. with EN 10305-3 externally zinc plated galvanised.
- System pipe made of non-alloy steel with the material number 1.0308 (E235), in acc. with EN 10305 externally galvanised with plastic coating made of polypropylene (PP) in white (RAL 9001).
- System pipe made of non-alloy steel with the material number 1.0215 (E220), in acc. with EN 10305 internally and externally sendzimir galvanised.

Areas of application

Heating systems
Industrial and plant engineering
Sprinkler units (sendzimir galvanised pipe)
Compressed air units (sendzimir galvanised pipe)
Solar systems
Air-conditioning systems

Use of the system for application areas and media other than those described here must be agreed with Viega Service Center.

Operating conditions with EPDM sealing element

- Operating temperature max. 110 °C
- Operating pressure max. 1.6 MPa (PN 16)

Use of press tools

The functional safety of the Viega press connector systems is primarily dependent on the perfect condition of the press tools and press machines used. For this reason, for the production of press connections, we recommend the use of Viega press tools and their regular inspection by authorised service points.

Technical data

Press connectors and components are constantly being optimised. If required, the current Z and installation dimensions can be obtained from the download area of the Viega homepage: viega.de/downloads

Storage and transport

To ensure the impeccable quality of the Prestabo steel pipes,

the following points should be observed during transport and storage:

- Packing and protective foil (only with PP coated pipes) should not be removed until immediately before use.
- The pipe ends must be closed with protective caps when delivered.
- Do not store the pipes directly on the bare floor.
- Do not stick any protective foils or plastics to the pipe surfaces.
- When loading and unloading, do not pull the steel pipes over the truck sill.

Protection against external corrosion

Prestabo pipes and connectors are protected by external galvanisation. In case of contact with dampness (condensation, precipitation during the construction phase, plaster and splash water etc.) or corrosive building materials (surfacers, levelling screed etc.), however this layer of zinc cannot provide permanent protection against external corrosion. The following protective measures are recommended:

- Use of closed-cell insulating tubes with professional sealing of all abutting and cut edges using a suitable filler.
- Damp-proofing of the laid pipe through separating foil in the floor construction.
- Installing pipes outside areas at risk of moisture.
- Visible radiator connections rising from the floors should be avoided if floors will be frequently cleaned with water and/or cleaning agents/disinfectants, for example in retirement homes and care homes as well as hospitals. Wall connections make cleaning easier and also exclude any additional risk of corrosion.
- If the radiator connections do come from the floor, professional corrosion protection and professional sealing of the joints must be ensured. If not, there is a possibility that the cleaning water will penetrate, which will moisten the insulation and present the risk of corrosion.

If the measures in the examples above fail to provide permanent protection against dampness or the areas of use are connected with special requirements, e.g. in cooling circuits, complete external corrosion protection, which reliably prevents influences that lead to corrosion must be applied.

Further detailed information and examples of use can be found in the practical handbook and on the internet.

INDEX

Elbows	4
T-pieces	7
Adapter pieces/adaptor elbows	10
Couplings	13
Reductions	14
Screw fittings	14
Caps, plugs	16
Flanges	16
Line manifold, cross pieces	18



GTIN-Code (Global Trade Item Number, previously EAN-Code)

The GTIN-Code composed out of the constant manufacturer number 4015211 and a six-digit article code - in this example 305 611. The exchange of the last six digits against the article code shows the GTIN-Code.

ELBOWS

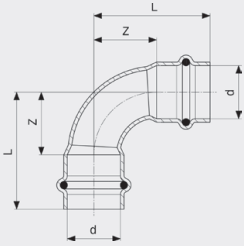

Prestabo Elbow 90°
- galvanised non-alloyed steel
Model 1116

article	d	Z	L	Z*	L*
605 162	12	14	32	17	35
558 123	15	16	38	26	48
558 130	18	18	40	36	58
558 147	22	26	49	44	67
558 154	28	34	58	48	72
558 161	35	32	59	59	86
558 178	42	50	87	71	107
558 185	54	65	105	92	132

Z* = previous version
L* = length of the previous version

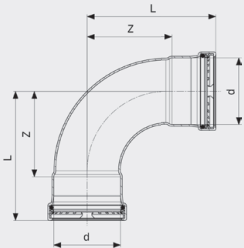

Prestabo XL Elbow 90°
- galvanised non-alloyed steel
Model 1116XL

article	d	Z	L
597 573	64.0	84	126
597 566	76.1	99	149
597 580	88.9	114	164
597 597	108.0	138	198

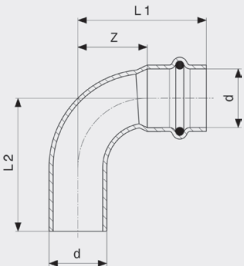

Prestabo Elbow 90°
- galvanised non-alloyed steel
Model 1116.1

article	d	Z	L1	L2	Z*	L1*	L2*
605 179	12	14	32	33			
558 192	15	16	38	40	26	48	53
558 208	18	18	40	42	30	52	63
558 215	22	26	49	50	37	60	77
558 222	28	34	58	59	48	72	82
558 239	35	32	59	62	59	86	96
558 246	42	50	87	88	71	107	117
558 253	54	65	105	107	92	132	142

Z* = previous version
L* = length of the previous version

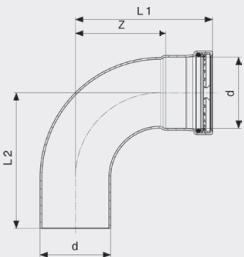

Prestabo XL Elbow 90°
- galvanised non-alloyed steel
Model 1116.1XL

article	d	Z	L1	L2
597 641	64.0	84	126	126
597 658	76.1	99	149	146
597 665	88.9	114	164	162
597 672	108.0	138	198	195

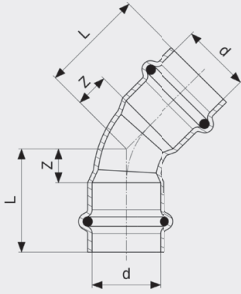

Prestabo Elbow 45°
- galvanised non-alloyed steel
Model 1126

article	d	Z	L	Z*	L*
604 448	12	6	24		
558 260	15	7	29		
558 277	18	7	29	13	35
558 284	22	11	34	22	45
558 291	28	14	38	21	45
558 307	35	15	41	28	54
558 314	42	21	57	33	69
558 321	54	27	67	44	84

Z* = previous version
L* = length of the previous version

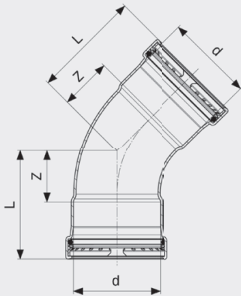

Prestabo XL Elbow 45°
- galvanised non-alloyed steel
Model 1126XL

article	d	Z	L
597 603	64.0	39	82
597 610	76.1	46	96
597 627	88.9	52	102
597 634	108.0	61	121

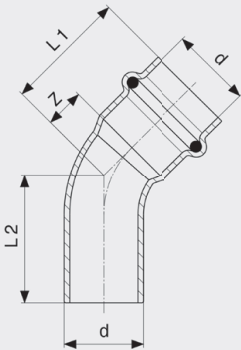

Prestabo Elbow 45°
- galvanised non-alloyed steel
Model 1126.1

article	d	Z	L1	L2	Z*	L1*	L2*
605 155	12	6	24	25			
558 338	15	7	29	29	13	35	39
558 345	18	7	29	30	15	37	47
558 352	22	11	34	35	17	40	58
558 369	28	14	38	39	21	45	55
558 376	35	15	41	42	28	54	64
558 383	42	21	57	59	34	69	79
558 390	54	27	67	69	44	84	94

Z* = previous version
L* = length of the previous version

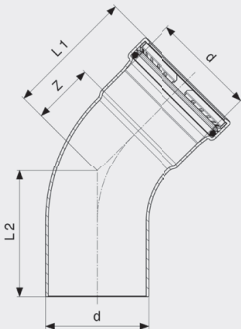

Prestabo XL Elbow 45°
- galvanised non-alloyed steel
Model 1126.1XL

article	d	Z	L1	L2
597 689	64.0	39	82	82
597 696	76.1	46	96	93
597 702	88.9	52	102	99
597 719	108.0	61	121	119

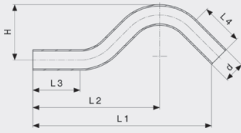

Prestabo Crossover
 - galvanised non-alloyed steel
Model 1109.3

article	VdS	d	L1	L2	L3	L4	H
605 186		12	132	91	34	35	42
601 232		15	153	104	39	39	48
601 249		18	175	118	45	45	53
601 256	✓	22	197	134	50	45	59

VdS = VdS certification

T-PIECES

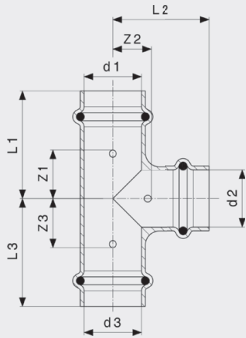

Prestabo T-piece
- galvanised non-alloyed steel
Model 1118

article	d1	d2	d3	Z1	Z2	Z3	L1	L2	L3
605 193	12	12	12	18	16	18	36	36	36
605 216	12	15	12	18	22	18	36	44	36
605 209	15	12	15	19	16	19	41	36	41
558 611	15	15	15	19	22	19	41	44	41
642 549	15	18	15	21	16	21	43	38	43
558 857	15	22	15	21	20	21	43	44	43
648 596	18	12	18	21	18	21	43	38	43
558 680	18	15	18	21	23	21	43	45	43
704 681	18	18	15	21	23	19	43	45	41
558 628	18	18	18	21	23	21	43	45	43
558 864	18	22	18	24	21	24	46	44	46
648 602	22	12	22	22	20	22	45	40	45
642 617	22	15	15	22	25	21	45	47	43
558 697	22	15	22	22	25	22	45	47	45
642 648	22	18	18	22	25	22	45	47	44
558 703	22	18	22	22	25	22	45	47	45
642 655	22	22	15	23	26	26	46	50	48
558 635	22	22	22	24	26	24	47	50	47
558 871	22	28	22	24	23	24	47	47	47
558 710	28	15	28	21	29	21	45	51	45
558 727	28	18	28	21	29	21	45	51	45
642 693	28	22	22	23	30	27	47	54	50
558 734	28	22	28	23	30	23	47	54	47
558 642	28	28	28	28	29	28	52	53	52
558 741	35	15	35	19	32	19	45	54	45
558 758	35	18	35	19	32	19	45	54	45
558 765	35	22	35	21	34	21	47	57	47
558 772	35	28	35	26	33	26	53	57	53
558 659	35	35	35	26	26	26	53	53	53
642 556	42	15	42	19	36	19	55	58	55
704 698	42	18	42	19	36	19	55	58	55
558 789	42	22	42	19	38	19	55	60	55
558 796	42	28	42	25	36	25	61	60	61
558 802	42	35	42	25	30	25	61	56	61
558 666	42	42	42	32	32	32	68	68	68
642 570	54	15	54	18	42	18	58	64	58
723 682	54	18	54	18	42	18	58	64	58
558 819	54	22	54	18	44	18	58	66	58
558 826	54	28	54	21	42	21	61	66	61
558 833	54	35	54	25	36	25	65	62	65
558 840	54	42	54	29	38	29	69	74	69
558 673	54	54	54	39	39	39	79	79	79

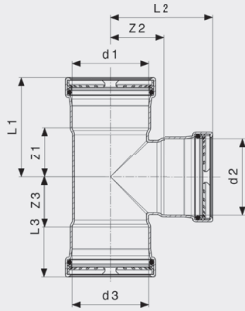

Prestabo XL T-piece
- galvanised non-alloyed steel
Model 1118XL

article	d1	d2	d3	Z1	Z2	Z3	L1	L2	L3
597 849	64.0	28	64.0	27	41	27	70	65	70
597 856	64.0	35	64.0	32	42	32	74	68	74
597 863	64.0	42	64.0	35	44	35	78	80	78
597 870	64.0	54	64.0	41	44	41	84	84	84
597 801	64.0	64.0	64.0	46	48	46	89	91	89
597 887	76.1	28	76.1	26	47	26	76	71	76
597 894	76.1	35	76.1	30	48	30	80	74	80
597 900	76.1	42	76.1	34	49	34	84	86	84
597 917	76.1	54	76.1	40	51	40	90	91	90
597 924	76.1	64.0	76.1	50	53	50	100	96	100
597 818	76.1	76.1	76.1	50	55	50	100	105	100
597 931	88.9	28	88.9	26	54	26	76	78	76
597 948	88.9	35	88.9	30	54	30	80	81	80
597 955	88.9	42	88.9	34	56	34	84	92	84
597 962	88.9	54	88.9	40	57	40	90	97	90
597 979	88.9	64.0	88.9	50	60	50	100	103	100
597 986	88.9	76.1	88.9	50	61	50	100	111	100
597 825	88.9	88.9	88.9	57	59	57	107	109	107
597 993	108.0	28	108.0	26	63	26	86	87	86
598 006	108.0	35	108.0	30	64	30	90	90	90
598 013	108.0	42	108.0	34	66	34	94	102	94
598 020	108.0	54	108.0	40	67	40	100	107	100
598 037	108.0	64.0	108.0	50	70	50	110	112	110
598 044	108.0	76.1	108.0	50	71	50	110	121	110
598 051	108.0	88.9	108.0	57	69	57	117	119	117
597 832	108.0	108.0	108.0	66	69	66	126	129	126

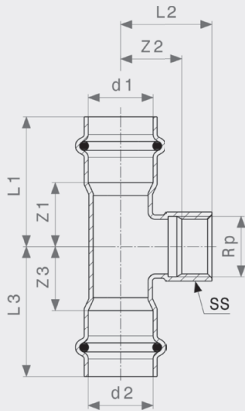

Prestabo T-piece
- galvanised non-alloyed steel
Model 1117.2

article	d1	Rp	d2	Z1	Z2	Z3	L1	L2	L3	SS
605 230	12	1/2	12	23	14	23	40	29	40	24
558 888	15	1/2	15	19	14	19	41	29	41	24
558 895	18	1/2	18	21	15	21	43	30	43	24
558 901	22	1/2	22	22	17	22	45	32	45	24
641 962	22	3/4	22	24	18	24	47	34	47	30
558 918	28	1/2	28	21	21	21	45	36	45	24
558 925	28	3/4	28	23	22	23	47	38	47	30
688 134	28	1	28	28	20	28	52	40	52	36
558 932	35	1/2	35	19	24	19	45	40	45	24
558 949	35	3/4	35	19	26	19	45	42	45	30
558 956	42	1/2	42	19	28	19	55	43	55	24
558 963	42	3/4	42	19	29	19	55	45	55	30
558 970	54	1/2	54	18	34	18	58	49	58	24
558 987	54	3/4	54	18	35	18	58	51	58	30
704 704	54	1	54	21	34	21	61	53	61	36

SS = wrench size

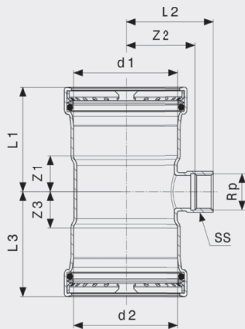

Prestabo XL T-piece
- galvanised non-alloyed steel
Model 1117.2XL

article	d1	Rp	d2	Z1	Z2	Z3	L1	L2	L3	SS
598 068	64.0	3/4	64.0	27	39	27	70	55	70	30
598 075	76.1	3/4	76.1	26	45	26	76	62	76	30
598 082	88.9	3/4	88.9	26	52	26	76	68	76	30
598 099	108.0	3/4	108.0	26	61	26	86	78	86	30

SS = wrench size

ADAPTER PIECES/ADAPTER ELBOWS

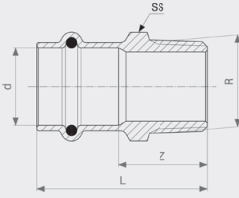

Prestabo Adapter
- galvanised non-alloyed steel
Model 1111

article	d	R	L	SS
605 247	12	3/8	40	22
648 626	12	1/2	42	22
558 994	15	3/8	42	24
559 007	15	1/2	46	24
641 979	15	3/4	49	27
559 014	18	1/2	46	27
559 021	18	3/4	49	27
641 986	22	1/2	48	27
559 038	22	3/4	49	27
704 797	22	1	54	34
721 428	28	1/2	50	34
641 993	28	3/4	52	34
559 045	28	1	54	34
642 006	28	1 1/4	62	46
704 803	35	1	60	36
559 052	35	1 1/4	62	46
642 013	35	1 1/2	65	50
704 810	42	1 1/4	77	55
559 069	42	1 1/2	72	55
588 663	54	2	82	70

SS = wrench size

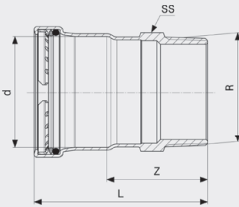

Prestabo XL Adapter
- galvanised non-alloyed steel
Model 1111XL

article	d	R	Z	L	SS
629 953	64.0	2	54	97	65
629 960	64.0	2 1/2	65	108	60
629 977	76.1	2 1/2	64	114	80
629 984	88.9	3	68	118	90
629 991	108.0	4	74	134	114

SS = wrench size

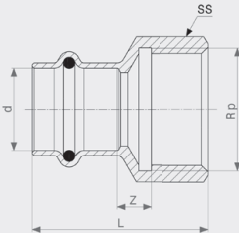

Prestabo Adapter
- galvanised non-alloyed steel
Model 1112

article	d	Rp	Z	L	SS
648 633	12	3/8	4	34	22
605 254	12	1/2	4	38	24
642 136	15	3/8	3	36	22
559 557	15	1/2	4	41	24
642 143	15	3/4	7	45	30
559 090	18	1/2	4	41	27
559 106	18	3/4	6	44	34
642 150	22	1/2	3	41	27
559 113	22	3/4	6	45	34
642 167	22	1	6	48	36
704 759	28	1/2	0	38	38
642 181	28	3/4	3	44	38
559 120	28	1	5	48	38
642 198	35	3/4	0	43	46
704 766	35	1	0	43	46
642 204	35	1 1/4	5	52	50
704 773	42	1 1/4	5	63	55
642 211	42	1 1/2	5	63	55
642 228	54	2	6	72	70

SS = wrench size

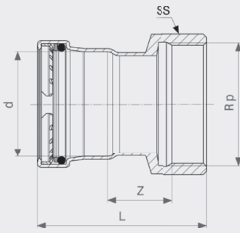

Prestabo XL Adapter
- galvanised non-alloyed steel
Model 1112XL

article	d	Rp	Z	L	SS
630 003	64.0	2	20	88	65
630 010	64.0	2½	25	98	82
630 034	76.1	2½	24	104	82
630 041	88.9	3	30	114	100
630 027	108.0	4	35	134	120

SS = wrench size

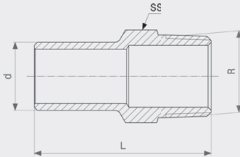

Prestabo Plug-in piece
- galvanised non-alloyed steel
Model 1111.1

article	d	R	L	SS
605 261	12	⅜	46	19
605 278	12	½	50	22
642 044	15	½	51	22
642 051	18	½	50	22
642 082	22	¾	54	30
642 099	28	1	59	36

SS = wrench size

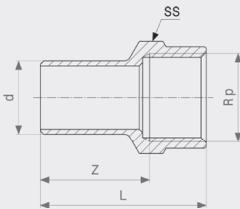

Prestabo Plug-in piece
- galvanised non-alloyed steel
Model 1112.1

article	d	Rp	Z	L	SS
559 137	15	½	32	47	27
559 144	18	½	31	46	27
559 151	18	¾	34	50	32
559 168	22	½	31	46	27
559 175	22	¾	33	50	32
704 780	28	1	36	49	36

SS = wrench size

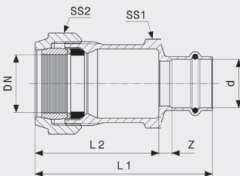

Sanpress Adapter
- gunmetal
Model 2215.6

article	DN	d	Z	L1	L2	SS1	SS2
588 564	25	28	8	104	72	50	55
588 328	32	35	8	112	78	68	70

SS = Spanner size
SS = spanner size

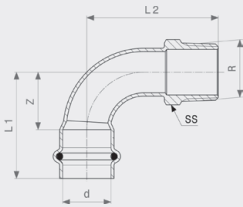

Prestabo Adapter elbow 90°
- galvanised non-alloyed steel
Model 1114

article	d	R	Z	L1	L2	SS	Z*	L1*	L2*	SS*
605 346	12	3/8	18	36	40	19				
648 640	12	1/2	18	36	42	22				
558 406	15	3/8	16	38	41	19	18	40	38	19
558 413	15	1/2	16	38	44	22	18	40	40	22
558 420	18	1/2	18	40	46	22	22	53	43	30
704 643	22	1/2	26	49	58	22				
558 437	22	3/4	26	49	61	27				
558 444	28	1	34	58	76	36				
558 451	35	1 1/4	33	58	78	46	46	86	91	59
558 468	42	1 1/2	50	87	102	50				
558 475	54	2	65	105	123	63				

SS = wrench size

Z* = previous version

L1* = length of the previous version

SS* = previous version (spanner size)

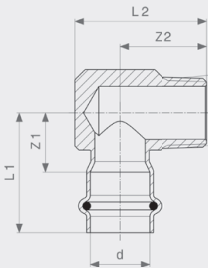

Prestabo Adapter elbow 90°
- galvanised non-alloyed steel
Model 1114.1

article	d	R	Z1	Z2	L1	L2
605 360	12	3/8	19	24	39	36
649 951	12	1/2	20	28	40	40
559 519	15	3/8	18	24	40	36
559 526	15	1/2	19	28	41	40
559 533	18	1/2	19	28	41	40
559 540	22	3/4	22	33	45	50
704 667	28	1	22	36	46	54

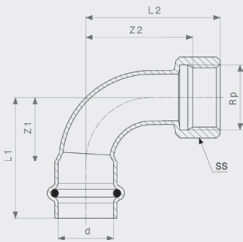

Prestabo Adapter elbow 90°
- galvanised non-alloyed steel
Model 1114.5

article	VdS	d	Rp	Z1	Z2	L1	L2	SS
605 353		12	3/8	17	21	36	32	22
651 398		12	1/2	18	23	36	38	24
601 300		15	1/2	16	24	38	39	24
601 317		18	1/2	18	27	40	42	26
704 650	✓	22	1/2	26	39	49	54	24
601 324	✓	22	3/4	26	39	49	55	30
601 331	✓	28	1	34	51	58	70	36

VdS = VdS certification

SS = wrench size

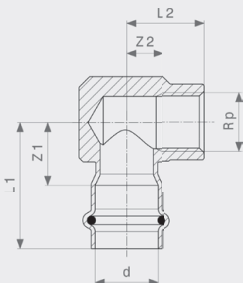

Prestabo Adapter elbow 90°
- galvanised non-alloyed steel
Model 1114.2

article	d	Rp	Z1	Z2	L1	L2
651 404	12	1/2	24	10	44	24
656 478	15	1/2	20	10	42	24
601 263	22	1/2	22	13	45	28
601 270	22	3/4	25	13	48	30
601 287	28	1/2	22	16	46	31
601 294	28	3/4	25	16	49	32
642 310	28	1	27	17	51	36

COUPLINGS

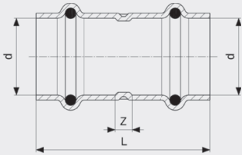

Prestabo Coupling
- galvanised non-alloyed steel
Model 1115

article	d	Z	L
604 424	12	1	39
557 980	15	12	56
557 997	18	11	55
558 000	22	12	58
558 017	28	12	60
558 024	35	12	64
558 031	42	12	84
558 048	54	12	92

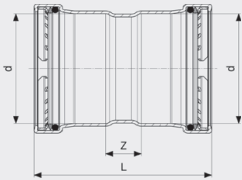

Prestabo XL Coupling
- galvanised non-alloyed steel
Model 1115XL

article	d	Z	L
597 726	64.0	24	110
597 733	76.1	25	125
597 740	88.9	25	125
597 757	108.0	25	145

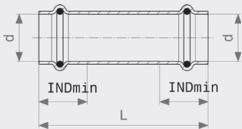

Prestabo Sliding coupling
- galvanised non-alloyed steel
Model 1115.5

article	d	L	INDmin
604 431	12	71	18
558 055	15	80	22
558 062	18	80	22
558 079	22	80	23
558 086	28	96	24
558 093	35	106	26
558 109	42	120	36
558 116	54	136	40

INDmin = insertion depth minimum

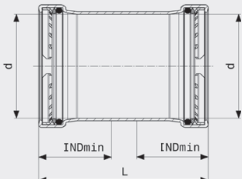

Prestabo XL Sliding coupling
- galvanised non-alloyed steel
Model 1115.5XL

article	d	L	INDmin
597 764	64.0	110	43
597 771	76.1	125	50
597 788	88.9	125	50
597 795	108.0	145	60

INDmin = insertion depth minimum

REDUCTIONS

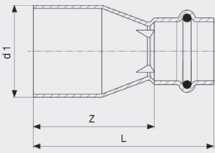

Prestabo Reducer
- galvanised non-alloyed steel
Model 1115.1

article	d1	d2	Z	L
605 315	15	12	28	48
605 322	18	12	30	50
558 499	18	15	30	52
605 339	22	12	35	55
558 505	22	15	35	57
558 512	22	18	37	59
558 529	28	15	50	72
558 536	28	18	47	69
558 543	28	22	42	64
642 730	35	15	56	78
558 550	35	22	50	74
558 567	35	28	43	67
642 761	42	22	65	88
642 778	42	28	66	90
558 574	42	35	54	80
704 728	54	18	90	112
558 581	54	22	90	113
558 598	54	28	85	109
642 792	54	35	81	107
558 604	54	42	65	101

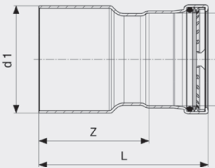

Prestabo XL Reducer
- galvanised non-alloyed steel
Model 1115.1XL

article	d1	d2	Z	L
598 105	64.0	54	71	110
704 742	76.1	35	88	114
704 735	76.1	42	86	123
598 129	76.1	54	83	123
598 112	76.1	64.0	82	125
598 136	88.9	54	90	130
598 143	88.9	64.0	89	132
598 150	88.9	76.1	82	132
598 167	108.0	54	110	150
598 174	108.0	64.0	109	152
598 181	108.0	76.1	101	151
598 198	108.0	88.9	95	145

SCREW FITTINGS

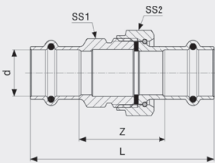

Prestabo Screw fitting
- galvanised non-alloyed steel
Model 1160

article	d	Z	L	SS1	SS2
642 358	12	32	68	24	24
559 304	15	33	77	30	30
559 311	18	34	78	30	30
559 328	22	38	84	36	37
559 335	28	42	90	46	46
559 342	35	42	94	50	53
559 359	42	43	115	55	60
559 366	54	53	133	70	78

SS = Spanner size
SS = spanner size

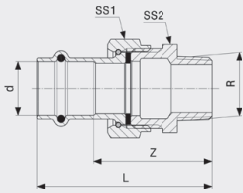

Prestabo Adapter union
- galvanised non-alloyed steel
Model 1165

article	d	R	Z	L	SS1	SS2
559 243	15	1/2	45	67	30	27
752 637	18	3/4	48	70	30	27
559 250	22	3/4	54	76	30	27
642 341	22	1	52	76	37	34
559 267	28	1	62	86	37	34
559 274	35	1 1/4	58	84	53	50
559 281	42	1 1/2	59	95	60	55
559 298	54	2	69	109	78	72

SS = Spanner size
SS = spanner size

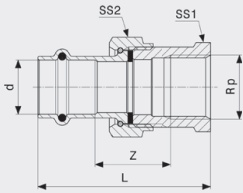

Prestabo Adapter union
- galvanised non-alloyed steel
Model 1162

article	d	Rp	Z	L	SS1	SS2
641 849	15	1/2	26	64	30	27
643 454	18	1/2	28	65	30	27
643 461	22	3/4	37	76	30	32
643 478	22	1	35	77	37	41
643 485	28	1	45	88	37	41
643 492	35	1 1/4	30	78	53	50
643 508	42	1 1/2	34	91	60	55
643 515	54	2	21	87	78	70

SS = Spanner size
SS = spanner size

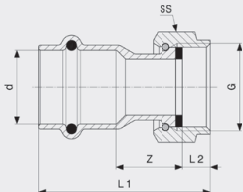

Prestabo Connection screw fitting
- galvanised non-alloyed steel
Model 1163

article	VdS	d	G	Z	L1	L2	SS
752 613		15	1/2	15	44	6	24
559 182		15	3/4	12	42	8	30
601 058		15	1	11	40	8	36
704 827	✓	18	3/4	14	44	8	30
601 065		18	1	11	40	8	36
693 091	✓	22	3/4	19	50	8	30
559 199	✓	22	1	12	44	8	37
601 072	✓	22	1 1/4	13	46	10	50
601 089	✓	22	1 1/2	14	48	11	52
559 205	✓	28	1 1/4	14	48	10	46
752 620	✓	28	1	22	54	8	37
601 102	✓	28	1 1/2	15	50	11	52
559 212	✓	35	1 1/2	12	49	10	53
601 119	✓	35	2	14	51	12	64
559 229	✓	42	1 3/4	12	58	10	60
601 126	✓	42	2	20	70	14	66
559 236	✓	54	2 3/8	15	68	12	78
601 133	✓	54	2 1/2	16	72	16	84

VdS = VdS certification
SS = wrench size

CAPS, PLUGS

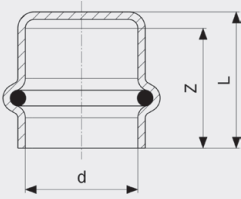

Prestabo Cap
- galvanised non-alloyed steel
Model 1156

article	d	Z	L
643 577	12	18	21
643 584	15	22	26
643 591	18	22	26
643 607	22	24	26
643 614	28	25	28
643 621	35	26	30
643 638	42	36	40
643 645	54	40	44

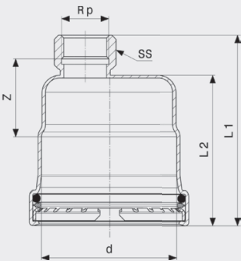

Prestabo XL Cap
- galvanised non-alloyed steel
Model 1156XL

article	d	Rp	Z	L1	L2	SS
598 242	64.0	3/4	39	99	78	30
598 259	76.1	3/4	39	105	84	30
598 266	88.9	3/4	39	105	84	30
598 273	108.0	3/4	39	115	94	30

SS = wrench size

FLANGES

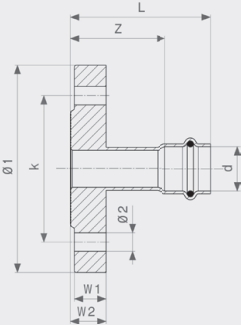

Prestabo Flange adapter
- galvanised non-alloyed steel
Model 1159.1

article	DN	d	Z	L	W1	W2	Ø1	k	Ø2	n
642 389	32	35	40	66	12	14	120	90	14	4
642 396	40	42	53	89	12	14	130	100	14	4
642 402	50	54	53	93	12	14	140	110	14	4

Ø = diameter
k = bolt circle diameter
Ø = diameter
n = number of holes

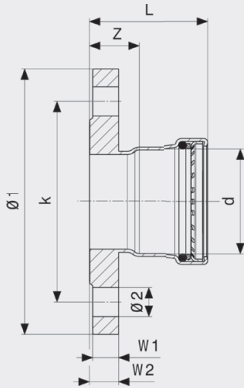

Prestabo XL Flange adapter
- galvanised non-alloyed steel
Model 1159.1XL

article	DN	d	Z	L	W1	W2	$\varnothing 1$	k	$\varnothing 2$	n
630 058	50	64.0	26	70	12	14	140	110	14	4
629 939	65	64.0	27	70	12	14	160	130	14	4
629 946	65	76.1	26	76	12	14	160	130	14	4
629 915	80	88.9	28	78	14	16	190	150	18	4
629 922	100	108.0	28	88	14	16	210	170	18	4

\varnothing = diameter
k = bolt circle diameter
 \varnothing = diameter
n = number of holes

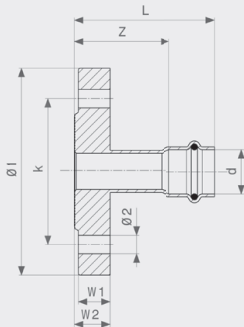

Prestabo Flange adapter
- galvanised non-alloyed steel
Model 1159

article	DN	d	Z	L	W1	W2	$\varnothing 1$	k	$\varnothing 2$	n
643 546	32	35	44	70	16	18	140	100	18	4
643 553	40	42	57	93	16	18	150	110	18	4
643 560	50	54	57	97	16	18	165	125	18	4

\varnothing = diameter
k = bolt circle diameter
 \varnothing = diameter
n = number of holes

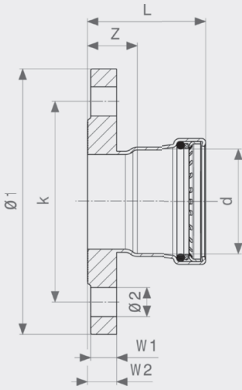

Prestabo XL Flange adapter
- galvanised non-alloyed steel
Model 1159XL

article	DN	d	Z	L	W1	W2	Ø1	k	Ø2	n
598 204	65	64.0	31	74	16	18	185	145	18	8
598 211	65	76.1	30	80	16	18	185	145	18	8
598 228	80	88.9	31	81	18	20	200	160	18	8
598 235	100	108.0	32	92	18	20	220	180	18	8

Ø = diameter
k = bolt circle diameter
Ø = diameter
n = number of holes

LINE MANIFOLD, CROSS PIECES

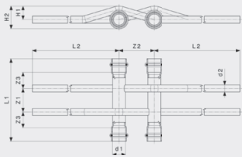

Prestabo Line manifold
Model 1149.7

article	d1	d2	Z1	Z2	Z3	L1	L2	H1	H2
664 084	15	12	40	60	28	140	500	20	31
664 091	15	15	40	60	28	140	500	22	34
664 107	18	12	40	60	28	140	500	21	34
664 169	18	15	40	60	28	140	500	24	37
664 176	22	12	40	60	27	140	500	23	39
664 138	22	15	40	60	27	140	500	26	42
664 183	28	12	40	60	26	140	500	26	45
664 152	28	15	40	60	26	140	500	29	48

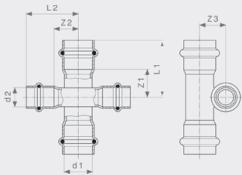

Prestabo Cross piece
- galvanised non-alloyed steel
Model 1148

article	d1	d2	Z1	Z2	Z3	L1	L2
601 157	18	15	21	19	18	43	41
601 164	22	15	22	19	20	45	41
601 171	28	15	21	19	24	45	41

order code	page	order code	page	order code	page	order code	page	order code	page
557 980	13	558 734	7	597 603	5	601 126	15	642 358	14
557 997	13	558 741	7	597 610	5	601 133	15	642 389	16
558 000	13	558 758	7	597 627	5	601 157	18	642 396	16
558 017	13	558 765	7	597 634	5	601 164	18	642 402	16
558 024	13	558 772	7	597 641	4	601 171	18	642 549	7
558 031	13	558 789	7	597 658	4	601 232	6	642 556	7
558 048	13	558 796	7	597 665	4	601 249	6	642 570	7
558 055	13	558 802	7	597 672	4	601 256	6	642 617	7
558 062	13	558 819	7	597 689	5	601 263	12	642 648	7
558 079	13	558 826	7	597 696	5	601 270	12	642 655	7
558 086	13	558 833	7	597 702	5	601 287	12	642 693	7
558 093	13	558 840	7	597 719	5	601 294	12	642 730	14
558 109	13	558 857	7	597 726	13	601 300	12	642 761	14
558 116	13	558 864	7	597 733	13	601 317	12	642 778	14
558 123	4	558 871	7	597 740	13	601 324	12	642 792	14
558 130	4	558 888	9	597 757	13	601 331	12	643 454	15
558 147	4	558 895	9	597 764	13	604 424	13	643 461	15
558 154	4	558 901	9	597 771	13	604 431	13	643 478	15
558 161	4	558 918	9	597 788	13	604 448	5	643 485	15
558 178	4	558 925	9	597 795	13	605 155	5	643 492	15
558 185	4	558 932	9	597 801	8	605 162	4	643 508	15
558 192	4	558 949	9	597 818	8	605 179	4	643 515	15
558 208	4	558 956	9	597 825	8	605 186	6	643 546	17
558 215	4	558 963	9	597 832	8	605 193	7	643 553	17
558 222	4	558 970	9	597 849	8	605 209	7	643 560	17
558 239	4	558 987	9	597 856	8	605 216	7	643 577	16
558 246	4	558 994	10	597 863	8	605 230	9	643 584	16
558 253	4	559 007	10	597 870	8	605 247	10	643 591	16
558 260	5	559 014	10	597 887	8	605 254	10	643 607	16
558 277	5	559 021	10	597 894	8	605 261	11	643 614	16
558 284	5	559 038	10	597 900	8	605 278	11	643 621	16
558 291	5	559 045	10	597 917	8	605 315	14	643 638	16
558 307	5	559 052	10	597 924	8	605 322	14	643 645	16
558 314	5	559 069	10	597 931	8	605 339	14	648 596	7
558 321	5	559 090	10	597 948	8	605 346	12	648 602	7
558 338	5	559 106	10	597 955	8	605 353	12	648 626	10
558 345	5	559 113	10	597 962	8	605 360	12	648 633	10
558 352	5	559 120	10	597 979	8	629 915	17	648 640	12
558 369	5	559 137	11	597 986	8	629 922	17	649 951	12
558 376	5	559 144	11	597 993	8	629 939	17	651 398	12
558 383	5	559 151	11	598 006	8	629 946	17	651 404	12
558 390	5	559 168	11	598 013	8	629 953	10	656 478	12
558 406	12	559 175	11	598 020	8	629 960	10	664 084	18
558 413	12	559 182	15	598 037	8	629 977	10	664 091	18
558 420	12	559 199	15	598 044	8	629 984	10	664 107	18
558 437	12	559 205	15	598 051	8	629 991	10	664 138	18
558 444	12	559 212	15	598 068	9	630 003	11	664 152	18
558 451	12	559 229	15	598 075	9	630 010	11	664 169	18
558 468	12	559 236	15	598 082	9	630 027	11	664 176	18
558 475	12	559 243	15	598 099	9	630 034	11	664 183	18
558 499	14	559 250	15	598 105	14	630 041	11	688 134	9
558 505	14	559 267	15	598 112	14	630 058	17	693 091	15
558 512	14	559 274	15	598 129	14	641 849	15	704 643	12
558 529	14	559 281	15	598 136	14	641 962	9	704 650	12
558 536	14	559 298	15	598 143	14	641 979	10	704 667	12
558 543	14	559 304	14	598 150	14	641 986	10	704 681	7
558 550	14	559 311	14	598 167	14	641 993	10	704 698	7
558 567	14	559 328	14	598 174	14	642 006	10	704 704	9
558 574	14	559 335	14	598 181	14	642 013	10	704 728	14
558 581	14	559 342	14	598 198	14	642 044	11	704 735	14
558 598	14	559 359	14	598 204	18	642 051	11	704 742	14
558 604	14	559 366	14	598 211	18	642 082	11	704 759	10
558 611	7	559 519	12	598 228	18	642 099	11	704 766	10
558 628	7	559 526	12	598 235	18	642 136	10	704 773	10
558 635	7	559 533	12	598 242	16	642 143	10	704 780	11
558 642	7	559 540	12	598 259	16	642 150	10	704 797	10
558 659	7	559 557	10	598 266	16	642 167	10	704 803	10
558 666	7	588 328	11	598 273	16	642 181	10	704 810	10
558 673	7	588 564	11	601 058	15	642 198	10	704 827	15
558 680	7	588 663	10	601 065	15	642 204	10	721 428	10
558 697	7	597 566	4	601 072	15	642 211	10	723 682	7
558 703	7	597 573	4	601 089	15	642 228	10	752 613	15
558 710	7	597 580	4	601 102	15	642 310	12	752 620	15
558 727	7	597 597	4	601 119	15	642 341	15	752 637	15

order code	page	order code	page	order code	page	order code	page	order code	page

model no.	page	model no.	page	model no.	page	model no.	page	model no.	page
1109.3	6								
1111	10								
1111.1	11								
1111XL	10								
1112	10								
1112.1	11								
1112XL	11								
1114	12								
1114.1	12								
1114.2	12								
1114.5	12								
1115	13								
1115.1	14								
1115.1XL	14								
1115.5	13								
1115.5XL	13								
1115XL	13								
1116	4								
1116.1	4								
1116.1XL	4								
1116XL	4								
1117.2	9								
1117.2XL	9								
1118	7								
1118XL	8								
1126	5								
1126.1	5								
1126.1XL	5								
1126XL	5								
1148	18								
1149.7	18								
1156	16								
1156XL	16								
1159	17								
1159.1	16								
1159.1XL	17								
1159XL	18								
1160	14								
1162	15								
1163	15								
1165	15								
2215.6	11								