

Propress With Smart Connect™

Piping technology
copper/gunmetal

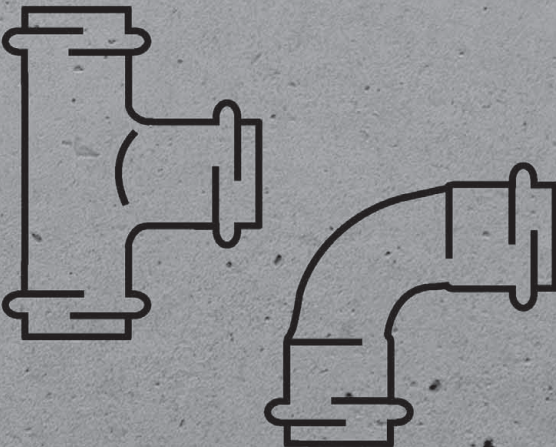

viega

System Description

Propress and Propress XL are safe, reliable, and economical copper pipe installation systems that use modern cold press connection technology for a wide assortment of more than 150 fittings in dimensions ranging from DN15 (1/2") to DN100 (4").

- Australian Watermark approval No WMKA21120, WMKA21120/2
- AS2419.1 compliant
- AS2441 compliant

Applications

Copper Tube: Type A, B, and C hard drawn copper tube from DN15 to DN100 and annealed copper tube in DN15 to DN40. All tube must comply with the AS1432 standard. Propress fittings are approved for installations in both above and below ground applications.

Operating Parameters:

Maximum safe working pressure (continuous operating pressure): 1600 kPa

Low Pressure Steam: <100 kPa & 120 °C

Continuous operating temperature: -25 to 110 °C, greater short duration peaks possible

Approved Applications:

- Potable water
- Solar systems (flat-panel and evacuated tube collectors) installations
- Hydronic heating (w/Glycol)
- Chilled water
- Compressed Air
- Low Pressure Steam

System Benefits

- Fast and Easy to Use
- Flameless
- Permanent Connections
- Wide range from DN15 to DN100
- Large Selection of Fittings
- Consistent Professional Appearance
- Less Equipment Required
- Environmentally Friendly Connection System
- Versatility of Fittings for Variety of Applications

Fittings

Viega Propress fittings are offered in 150+ configurations including: Elbows, Couplings, Reducers, Tees, Reducing Tees, Threaded Adapters, Unions, Caps, and Flanges. All Threaded 1/2" – 2" fittings are bronze.

Smart Connect (SC Feature)

In Propress DN15–DN100 dimensions, the Smart Connect Feature assures leakage of liquids and/or gases from inside the system past the sealing element of an unpressed connection. The function of this feature is to provide the installer quick and easy identification of connections which have not been pressed prior to putting the system into operation. This feature has a guaranteed functional range of 2.2–300 kPa for a dry leakage test and 100–650 kPa for a wet leakage test.

Use of press tools

The functional safety of the Viega press connector systems is primarily dependent on the perfect condition of the press tools and press machines used. For this reason, for the production of press connections, we recommend the use of Viega press tools and their regular inspection by authorised service points.

History

Propress has been used in Europe since the late 1980s and in the U.S. since the late 1990s for a variety of applications. Viega Propress was introduced to Australia in 2006. A world leading plumbing company with over 100 years of excellence back Viega Propress.

Warranty

Viega Propress fittings carry a 25-year warranty against defects in material and workmanship when to specification on AS1432 complying copper tube.

Approvals and Certificates

INDEX

Elbows	4
T-pieces	6
Adapters	7
Flanges	8
Caps	9
Screw fittings	9
Reductions	10



GTIN-Code (Global Trade Item Number, previously EAN)
 The GTIN-Code composed out of the constant manufacturer number 4015211 and a six-digit article code - in this example 305 611. The exchange of the last six digits against the article code shows the GTIN-Code (4015211 305 611).

ELBOWS

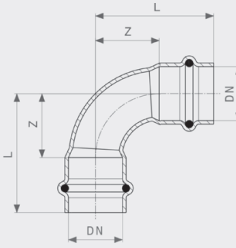

Propress elbow 90°
- Copper
Model 0716

article	DN	Z	L
579 401	15	14	32
579 418	20	22	44
579 425	25	30	54
579 432	32	35	60
579 449	40	46	76
579 456	50	61	100

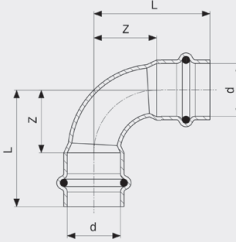

Profipress elbow 90°
- Copper
Model 2416

article	L	Z
443 870	38	19

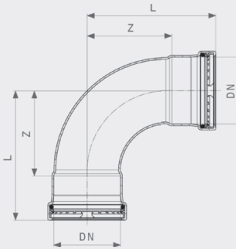

Propress XL elbow 90°
- Copper
Model 0716XL

article	DN	Z	L
591 588	65	84	126
591 595	80	99	149
591 601	100	122	182

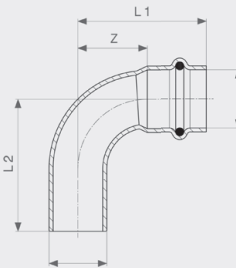

Propress elbow 90°
- Copper
Model 0716.1

article	Z	L1	L2
579 463	14	32	34
579 470	22	44	46
579 487	30	54	56
579 494	35	60	62
579 500	46	76	78
579 517	61	100	102

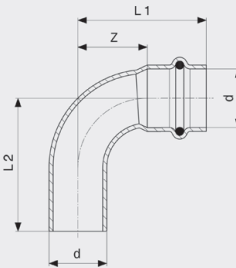

Profipress elbow 90°
- Copper
Model 2416.1

article	Z	L1	L2
444 105	19	38	39

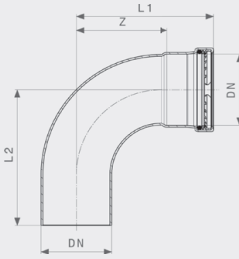

Propress XL elbow 90°
- Copper
Model 0716.1XL

article	DN	Z	L1	L2
591 618	65	84	126	126
591 625	80	99	149	146
591 632	100	122	182	178

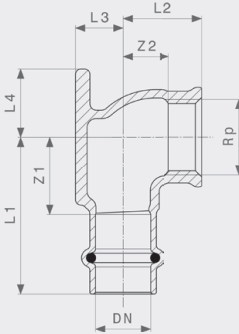

Propress wall plate
- Gunmetal
Model 0725.5

article	DN	Rp	Z1	Z2	L1	L2	L3	L4
579 920	15	1/2	25	11	42	20	11	22
579 937	20	3/4	26	15	48	25	15	22
700 966*	20	1/2						

* = Discontinued, limited availability.

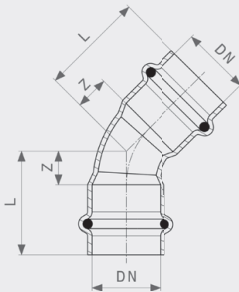

Propress elbow 45°
- Copper
Model 0726

article	DN	Z	L
700 904	15		
700 911	20		
579 968	25	13	36
579 975	32	14	40
579 982	40	19	50
579 999	50	25	64

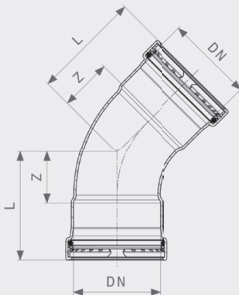

Propress XL elbow 45°
- Copper
Model 0726XL

article	DN	Z	L
591 793	65	39	82
591 809	80	46	96
591 816	100	58	118

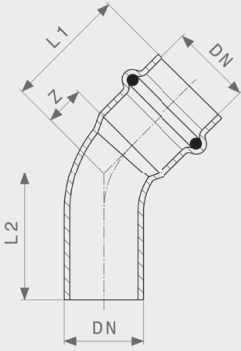

Propress elbow 45°
- Copper
Model 0726.1

article	DN	Z	L1	L2
700 928	15			
700 935	20			
580 001	25	13	36	38
580 018	32	14	40	42
580 025	40	19	50	52
580 032	50	25	64	66

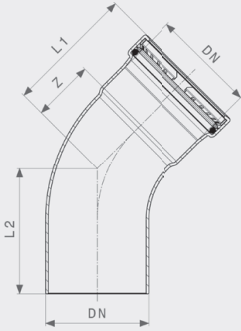

Propress XL elbow 45°
- Copper
Model 0726.1XL

article	DN	Z	L1	L2
591 823	65	39	82	82
591 830	80	46	96	93

T-PIECES

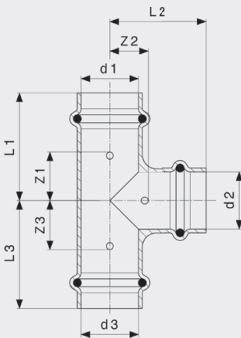

Profipress T-piece
- Copper
Model 2418

article	Z1	Z2	Z3	L1	L2	L3
443 894	19	13	19	38	32	38

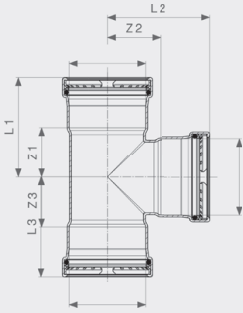

Propress XL T-piece
- Copper
Model 0718XL

article	DN1	DN2	DN3	Z1	Z2	Z3	L1	L2	L3
591 731	65	65	50	41	43	41	84	82	84
591 700	65	65	65	46	47	46	89	90	89
591 748	80	80	50	40	51	40	90	90	90
591 755	80	80	65	43	53	43	93	96	93
591 717	80	80	80	50	54	50	100	104	100
591 762	100	100	50	45	64	45	105	103	105
591 779	100	100	65	45	67	45	105	110	105
591 786	100	100	80	52	67	52	112	117	112
591 724	100	100	100	68	68	68	128	128	128

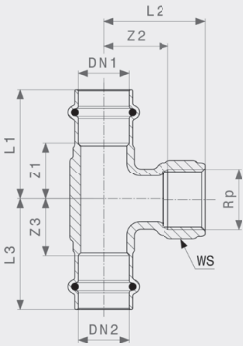

Propress T-piece
- Gunmetal
Model 0717.2

article	DN1	DN2	Rp	Z1	Z2	Z3	L1	L2	L3	WS
579 678	25	25	1/2	22	27	22	45	42	45	26
579 685	25	25	3/4	24	31	24	48	47	48	32
579 692	32	32	1/2	22	30	22	48	45	48	26
579 708	32	32	3/4	22	34	22	48	50	48	32
579 715	40	40	1/2	22	35	22	52	50	52	26
579 722	50	50	3/4	28	44	28	68	60	68	32

WS = wrench size

ADAPTERS

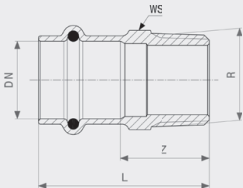

Propress adapter
- Gunmetal
Model 0711

article	DN	R	Z	L	WS
579 616	15	1/2	25	42	19
700 638	20	1/2	23	45	23
579 623	20	3/4	26	48	24
579 630	25	1	31	54	34
700 645	25	3/4	26	49	30
579 647	32	1 1/4	33	58	43
579 654	40	1 1/2	35	66	50
579 661	50	2	40	79	62

WS = wrench size

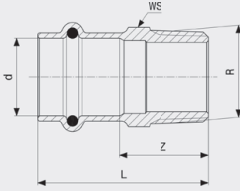

Sanpress adapter
- Bronze
Model 2211

article	DN	R	Z	L	WS	Z*	L*	WS*
443 702	18	1/2	22	41	22			
443 719	18	3/4	25	44	27			

WS = wrench size
Z* = Z-dimension of the previous version
L* = length of the previous version
WS* = previous version (wrench size)

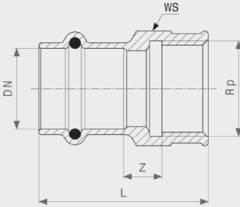

Propress adapter
- Gunmetal
Model 0712

article	DN	Rp	Z	L	WS
579 555	15	1/2	8	40	26
579 562	20	3/4	6	44	30
579 579	25	1	6	48	38
579 586	32	1 1/4	4	50	47
579 593	40	1 1/2	10	62	53
579 609	50	2	10	75	66

WS = wrench size

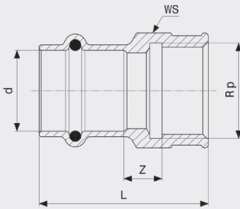

Sanpress adapter
- Bronze
Model 2212

article	Rp	Z	L	WS
443 733	1/2	7	41	26

WS = wrench size

FLANGES

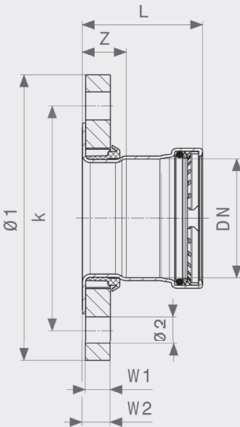

Propress XL flange adapter
- Copper
Model 0759.5XL

article	DN	Z	L	Ø1	k	W1	W2	Ø2	n
591 885	65	28	72	165	127	16	18	18	4
591 892	80	28	78	185	146	16	18	18	4
591 908	100	32	92	215	178	18	20	18	8

Ø = diameter
k = bolt circle diameter
Ø = diameter
n = number of holes

CAPS

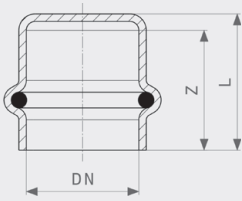

Propress cap
- Copper
Model 0756

article	DN	Z	L
582 746	15	20	23
582 753	20	24	27
580 049	25	25	28
580 056	32	28	31
580 063	40	34	37
580 070	50	42	45

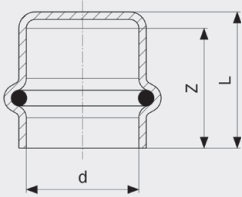

Profipress cap
- Copper
Model 2456

article	Z	L
444 082	21	24

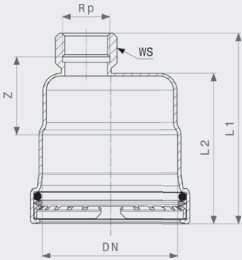

Propress XL cap
- Copper
Model 0756XL

article	DN	Rp	Z	L1	L2	WS
591 854	65	3/4	42	101	78	30
591 861	80	3/4	41	107	84	30
591 878	100	3/4	42	118	96	30

WS = wrench size

SCREW FITTINGS

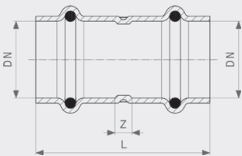

Propress coupling
- Copper
Model 0715

article	DN	Z	L
579 159	15	4	40
579 166	20	4	48
579 173	25	4	50
579 180	32	4	54
579 197	40	4	66
579 203	50	4	82

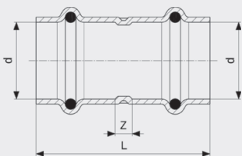

Profipress coupling
- Copper
Model 2415

article	Z	L
443 856	3	41

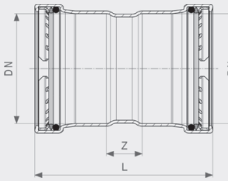

Propress XL coupling
- Copper
Model 0715XL

article	DN	Z	L
578 954	65	24	110
578 961	80	25	125
578 978	100	27	147

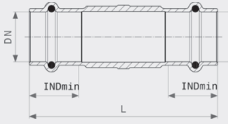

Propress sliding coupling
- Copper
Model 0715.5

article	DN	L	INDmin
579 340	15	43	18
700 959	18		
579 357	20	53	22
579 364	25	50	23
579 371	32	54	25
579 388	40	72	31
579 395	50	88	39

INDmin = insertion depth minimum

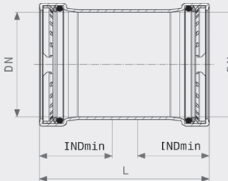

Propress XL sliding coupling
- Copper
Model 0715.5XL

article	DN	L	INDmin
591 557	65	110	43
591 564	80	125	50
591 571	100	147	60

INDmin = insertion depth minimum

REDUCTIONS

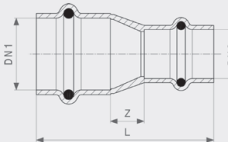

Propress reducing coupling
- Copper
Model 0715.2

article	DN1	DN2	Z	L
673 628	18	15	8	46
579 210	20	15	10	50
673 611	20	18	8	48
579 227	25	15	17	58
579 234	25	20	11	56
579 241	32	15	24	67
579 258	32	20	18	65
579 265	32	25	14	62
579 272	40	20	24	78
579 289	40	25	18	72
579 296	40	32	11	67
579 302	50	20	38	100
579 319	50	25	32	94
579 326	50	32	25	89
579 333	50	40	18	88

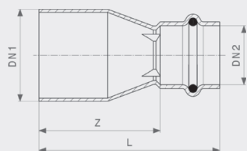

Propress reducer
- Copper
Model 0715.1

article	DN1	DN2	Z	L
623 432	20	15	37	55
623 449	25	15	45	63
624 958	25	20	37	59
624 965	32	20	47	69
624 972	32	25	39	62
669 003	40	20	56	78
669 010	40	25	49	72
669 027	40	32	42	66
669 034	50	25	72	95
669 041	50	32	64	89
669 058	50	40	56	87

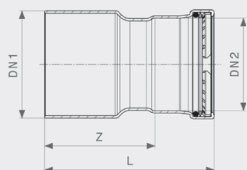

Propress XL reducer
- Copper
Model 0715.1XL

article	DN1	DN2	Z	L
624 507	65	40	69	100
624 514	65	50	61	100
624 545	80	50	94	133
624 538	80	65	92	135
624 552	100	50	117	156
624 569	100	65	115	158
624 576	100	80	107	157

article no.	page	article no.	page	article no.	page	article no.	page	article no.	page
443 702	8	580 025	6						
443 719	8	580 032	6						
443 733	8	580 049	9						
443 856	9	580 056	9						
443 870	4	580 063	9						
443 894	6	580 070	9						
444 082	9	582 746	9						
444 105	4	582 753	9						
578 954	10	591 557	10						
578 961	10	591 564	10						
578 978	10	591 571	10						
579 159	9	591 588	4						
579 166	9	591 595	4						
579 173	9	591 601	4						
579 180	9	591 618	5						
579 197	9	591 625	5						
579 203	9	591 632	5						
579 210	10	591 700	7						
579 227	10	591 717	7						
579 234	10	591 724	7						
579 241	10	591 731	7						
579 258	10	591 748	7						
579 265	10	591 755	7						
579 272	10	591 762	7						
579 289	10	591 779	7						
579 296	10	591 786	7						
579 302	10	591 793	5						
579 319	10	591 809	5						
579 326	10	591 816	5						
579 333	10	591 823	6						
579 340	10	591 830	6						
579 357	10	591 854	9						
579 364	10	591 861	9						
579 371	10	591 878	9						
579 388	10	591 885	8						
579 395	10	591 892	8						
579 401	4	591 908	8						
579 418	4	623 432	11						
579 425	4	623 449	11						
579 432	4	624 507	11						
579 449	4	624 514	11						
579 456	4	624 538	11						
579 463	4	624 545	11						
579 470	4	624 552	11						
579 487	4	624 569	11						
579 494	4	624 576	11						
579 500	4	624 958	11						
579 517	4	624 965	11						
579 555	8	624 972	11						
579 562	8	669 003	11						
579 579	8	669 010	11						
579 586	8	669 027	11						
579 593	8	669 034	11						
579 609	8	669 041	11						
579 616	7	669 058	11						
579 623	7	673 611	10						
579 630	7	673 628	10						
579 647	7	700 638	7						
579 654	7	700 645	7						
579 661	7	700 904	5						
579 678	7	700 911	5						
579 685	7	700 928	6						
579 692	7	700 935	6						
579 708	7	700 959	10						
579 715	7	700 966	5						
579 722	7								
579 920	5								
579 937	5								
579 968	5								
579 975	5								
579 982	5								
579 999	5								
580 001	6								
580 018	6								

model no.	page	model no.	page	model no.	page	model no.	page	model no.	page
0711	7								
0712	8								
0715	9								
0715.1	11								
0715.1XL	11								
0715.2	10								
0715.5	10								
0715.5XL	10								
0715XL	10								
0716	4								
0716.1	4								
0716.1XL	5								
0716XL	4								
0717.2	7								
0718XL	7								
0725.5	5								
0726	5								
0726.1	6								
0726.1XL	6								
0726XL	5								
0756	9								
0756XL	9								
0759.5XL	8								
2211	8								
2212	8								
2415	9								
2416	4								
2416.1	4								
2418	6								
2456	9								